

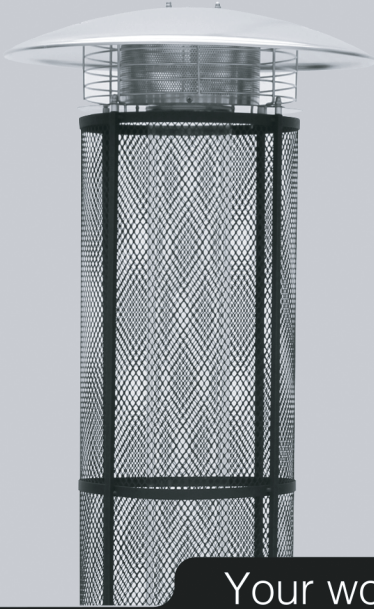

ALVA

PATIO HEATER FLAME TUBE

GHP26



Your world is better with Alva

- THIS IS A LOW PRESSURE APPLIANCE TO BE USED ONLY WITH A 2.8kPa SANS 1237 REGULATOR AND SANS 1156-2 APPROVED HOSE. (REGULATOR AND HOSE SUPPLIED)
- FOR YOUR OWN SAFETY, PLEASE READ THIS MANUAL CAREFULLY AND ALWAYS OPERATE THIS PRODUCT ACCORDING TO THE INSTRUCTIONS
- IT IS ILLEGAL AND DANGEROUS TO CHANGE OR MODIFY ANY PART OF THIS APPLIANCE

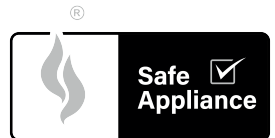

APPROVED FOR USE IN
SOUTH AFRICA

Manufactured for
and distributed by:



ALVA

A division of Stingray Accessory Manufacturers (Pty) Ltd | P.O. Box 30014, Tokai, 7966
+27 21 442 1540 | info@stingray.co.za | www.alva.co.za

TOLL FREE NUMBER: 086 100 ALVA (2582)

 /AlvaGas

/alvagas

IMPORTANT SAFETY INFORMATION

As with all gas appliances, misuse of this appliance or failure to fully follow these instructions may cause fire, injury or death. Please read all the instructions before using your gas heater.

- THIS UNIT MUST BE THOROUGHLY CHECKED BEFORE USE.
- Ensure that all the gas fittings are correctly and firmly fitted before every use.
- Remove all packaging materials before assembling.
- For OUTDOOR USE ONLY. Not for commercial use.
- For use with LP gas only
- DO NOT use within 1m of any flammable surfaces
- DO NOT use this patio heater if you do not clearly understand the instructions and/or how to operate the controls.
- Phone the customer care line at 086 100 ALVA (2582) or email info@stingray.co.za for assistance.
- DO NOT store flammable materials or another cylinder near the patio heater.
- DO NOT leave the heater unattended while in use.
- Ensure that the gas supply is turned OFF at the cylinder after use and while the heater is unattended.
- DO NOT move the heater while in use.
- DO NOT place objects on or against the heater.
- DO NOT use a naked flame to test for leaks. Follow the Leak Testing procedure outlined under 'LEAK TEST'.
- Leak test the patio heater every year or if you ever smell gas
- NEVER use this heater with a cylinder other than the size recommended.
- DO NOT unscrew the regulator while the patio heater is on or if the cylinder valve is open.
- DO NOT use a patio heater you suspect is faulty.
- For safety reasons, only a qualified technician may execute maintenance and repairs.
- The warranty for the patio heater will be rendered void if the patio heater is serviced or repaired by any one other than an Alva appointed technician.
- The patio heater should be inspected once a year by a qualified technician, to make sure the unit is safe and fault free.
- The operator is responsible for the safety of all third parties while the heater is in use.
- DO NOT use in windy or gusty conditions.
- Accessible parts may get very hot during operation. Keep young children at a safe distance.
- Clean with warm soapy water only after the heater has cooled down.
- Keep the burner unit clear of spider webs or other obstructions.
- Close the gas cylinder valve off after use.
- Any modification of this heater is dangerous.
- If you smell gas, close the cylinder valve immediately.



Please read the instructions carefully before use.

Retain this manual for future reference.

INDEX

WARRANTY	1
GENERAL INFORMATION	1
ASSEMBLY	2
HEATER SET UP	2
PARTS DIAGRAM	3
ASSEMBLY PARTS	4
PARTS LISTING AND TOOLS REQUIRED	5
ASSEMBLY INSTRUCTIONS	6 - 9
LOCATION	9
LEAK TEST	10
USING YOUR HEATER	11
FLASHBACK (Flames in the burner tube)	12
CHANGING YOUR CYLINDER	12
MAINTENANCE	13 - 14
FREQUENTLY ASKED QUESTIONS	14 - 15
TROUBLE SHOOTING GUIDE	15
SPECIFICATIONS	16
AFTER SALES SERVICE	16

KEY



Important information



Cautions and warnings.



Danger



Contact an approved ALVA technician.



Do It Yourself



Instructional video available

WARRANTY

PLEASE RETAIN YOUR PROOF OF PURCHASE FOR WARRANTY CLAIMS.

ALVA warrants this appliance to be free of defects in material and quality for a period of 12 months from date of original purchase. This warranty covers the intended use of this appliance – within a domestic setting and not for commercial or industrial purposes. Any damage caused by willful abuse, tampering, modification or unauthorized repair will not be warranted.

Please retain all packaging material, as items returned without original packaging material may be subject to a withholding fee. Where this appliance is found to be defective, damaged, broken, or does not work correctly for the intended purpose, you must return the appliance to the retailer from where it was purchased. The warranty will only be effected with valid proof of purchase. Failure to provide the proof of purchase will most likely result in the repair or service required being chargeable.

If you have any questions while setting up or using this heater, please visit www.alva.co.za or call 086 100 ALVA (2582) or e-mail info@stingray.co.za

GENERAL INFORMATION

Before using this heater, please read through this manual and make sure you understand everything. If you are not sure, call **086 100 ALVA (2582)** or visit www.alva.co.za for help. This heater is a safe and efficient form of heating when used according to these instructions.

Reading and understanding this manual should give you a good indication of what to expect from your Alva gas heater. If this product is not what you want or need, please help Alva and the environment by not damaging or destroying any part of the packaging, the manual or the Styrofoam inserts. Always keep your proof of purchase. Keep these instructions for future use. If you lose this copy, you can obtain a new copy from your dealer or online at www.alva.co.za.

This appliance operates on a 2.8kPa SANS 1237 approved regulator. Regulator and hose included.



Thank you for your purchase of this Patio heater. Please read these instructions carefully before use and keep them in a safe place, for future reference.



Not using gas and/ or gas appliances according to the instructions is extremely dangerous and can lead to property damage, injury or death.

For outdoor use only.

For use with LPG only

DO NOT use within 1m of any flammable surfaces.

Always turn OFF the gas supply at the cylinder after use.

DO NOT store flammable materials or another cylinders near the heater.

ASSEMBLY

Remove all packaging materials before assembling the patio heater.

Before Assembly:

- Please read all instructions thoroughly before proceeding with the appliance assembly.
- Find a large clean area in which to assemble the patio heater.
- Please refer to the parts list and diagrams. (see page 3)
- Assembly of the heater involves large components and it is advisable to have two people to assemble the unit.

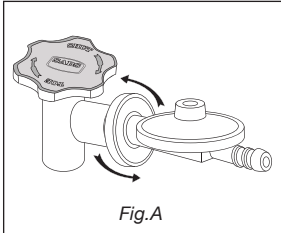

This patio heater makes use of an industrial cylinder (9kg ALVA cylinder recommended) with a 5/8" BSP thread; horizontal exit valve.

The Bullnose regulator supplied with the heater tightens to the left hand side (anti-clockwise). (Figure A).

If you have bought a new gas cylinder, the cylinder needs to be purged (emptied out), before its first use. If it is not purged of air, the heater will not work properly. This should happen at the gas filling station when you fill up the cylinder. Always check this with your gas supplier.

HEATER SET UP

1. Before removing this heater from the packaging, read this manual in full and make sure that it is what you want /need.
2. Remove the heater from the packaging
3. Check if the nose cone sealing washer is in place, secure and in good condition. (Figure B)
4. The regulator goes directly into the cylinder valve. Always ensure that the regulator is correctly and firmly fastened in place. The use of any adaptors is illegal.

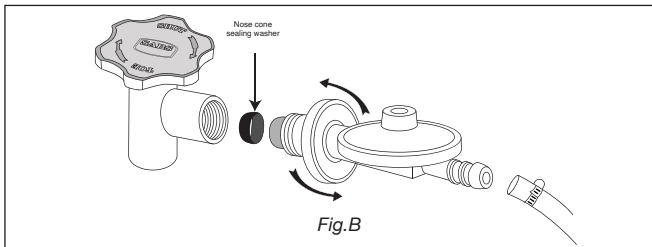

Your heater should be checked once a year by a qualified technician. Take special care to retighten any fixtures or nuts and bolts that have come loose.

PARTS DIAGRAM

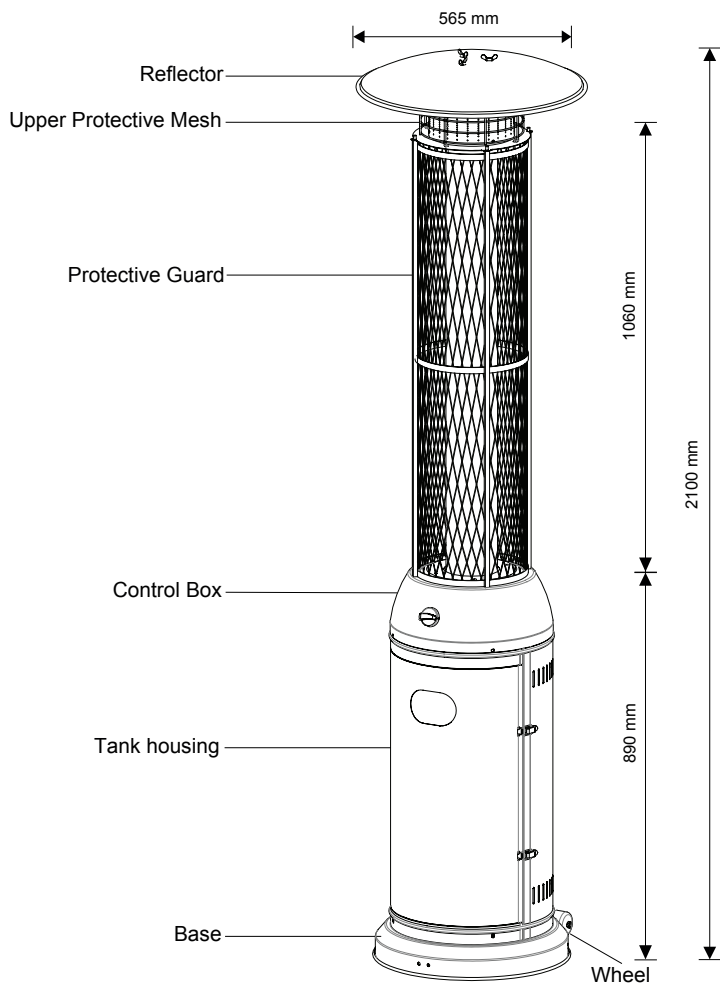

ASSEMBLY PARTS

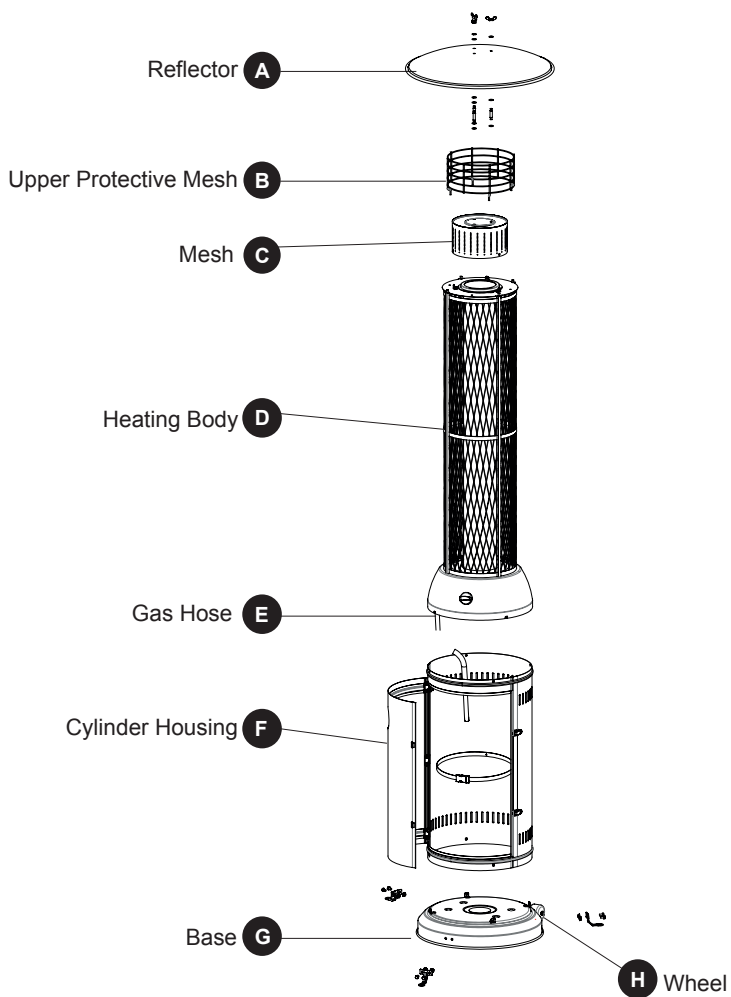

PART	DESCRIPTION	QUANTITY
A	Reflector	1
B	Upper Protective Mesh	1
C	Mesh	1
D	Heating Body	1
E	Gas Hose	1
F	Cylinder Housing	1
G	Base	1
H	Wheel	1

PARTS LISTING AND TOOLS REQUIRED

AA

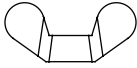

Wing nut
Qty. 3

BB

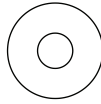

Washer $\Phi 6$
Qty. 15

CC

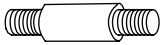

Stud
Qty. 3

DD

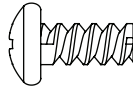

Screw M5 X 10
Qty. 11

EE

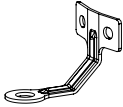

Ground Fixer
Qty. 3

FF

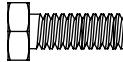

Bolt M6 x 10
Qty. 6

GG



Nut M6
Qty. 6

HH

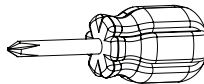

Philips
screwdriver
Qty. 1

II

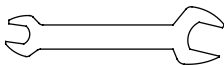

Wrench
Qty. 1

ASSEMBLY INSTRUCTIONS

STEP 1

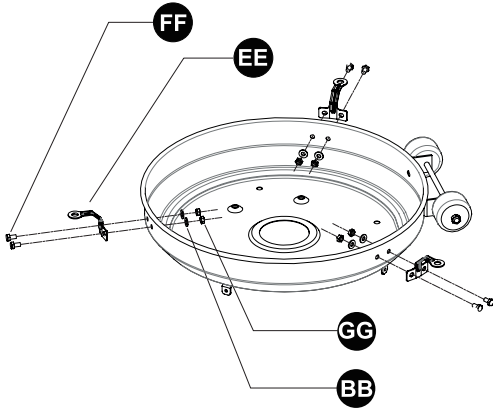

To protect your heater from strong winds, anchor the base securely to the ground with screws. Reverse the base, fix the ground fixer to the base with bolt M6x10 and washer Ø6 as illustrated in the diagram. Secure the ground fixer with nut M6. Fix another two ground fixers with bolts and nuts, and reverse the base.

- BB** Washer Ø6 x 6
- EE** Ground Fixer x 3
- FF** Bolt M6X10 x 6
- GG** Nut M6 x 6
- II** Wrench x 1

STEP 2

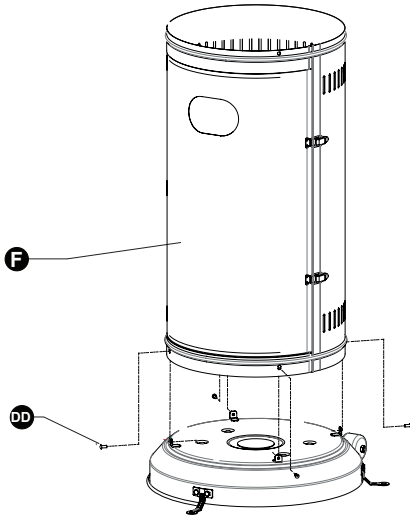

- DD** Screw M5X10 x 4
- HH** Philips screwdriver x 1

Assemble the tank housing. Secure the tank housing to the base using the 4pcs screw M5x10.

STEP 3

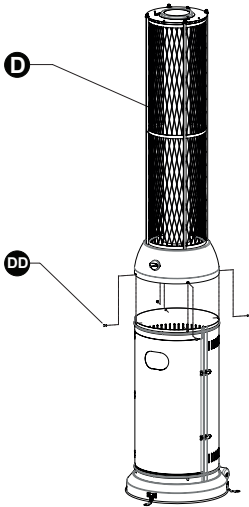

Assemble the heating body.
Secure the heating body to the tank housing using the 4pcs screw M5x10.

DD Screw M5X10  x 4

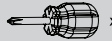
HH Philips screwdriver  x 1

STEP 4

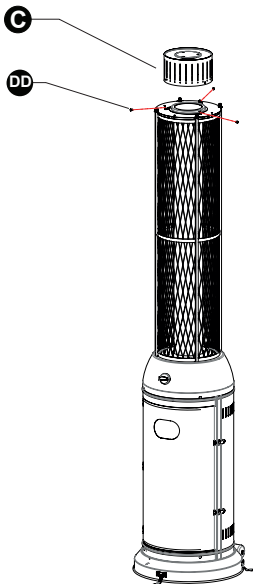

Assemble the mesh.
Secure the mesh to the heating body using the 3pcs screw M5x10.

DD Screw M5X10  x 3

HH Philips screwdriver  x 1

STEP 5

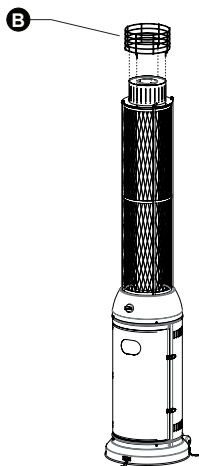

Assemble the upper protective mesh directly to the heating body directly.

CAUTION:

Do not hang clothing or any other flammable material from the heater, or place on or near the heater.

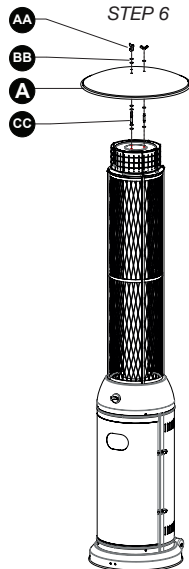

HOT! DO NOT TOUCH!

STEP 6



Assemble the reflector.

- Screw 3pcs stud to the top of the mesh, using 3pcs washer $\text{\O}6$ to the bottom and 3pcs washer $\text{\O}6$ to the top.
- Put the reflector on the stud and secure them using 3pcs wing nuts and 3pcs washer.

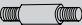
AA	Wing nut		x 3
BB	Washer $\text{\O}6$		x 9
CC	Stud		x 3

STEP 7

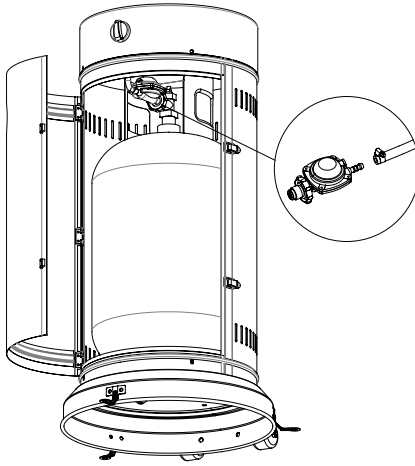

Connect the gas hose and regulator to the heater.
Once connected, connect to the gas cylinder.

Warning :
Ensure the hose does not make contact with any high temperature surfaces, or it may melt and leak causing a fire.

The LP regulator/hose assembly must be located out of pathways where people may trip over it or in an area where the hose will not be subject to accidental damage.

LOCATION

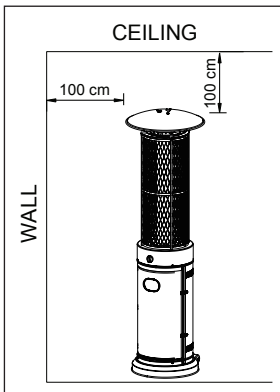

- FOR OUTDOOR USE ONLY.
- Always ensure adequate ventilation is provided.
- Maintain proper clearance from combustible materials i.e. 100cm from the sides and top.
- Heater must be placed on level firm ground.
- NEVER operate the heater in the vicinity of combustible materials.
- Use base screws to anchor the unit if there is a possibility of strong wind.

LEAK TEST

The leak test must be carried out in a well-ventilated area, free from any flames or other sources of ignition.

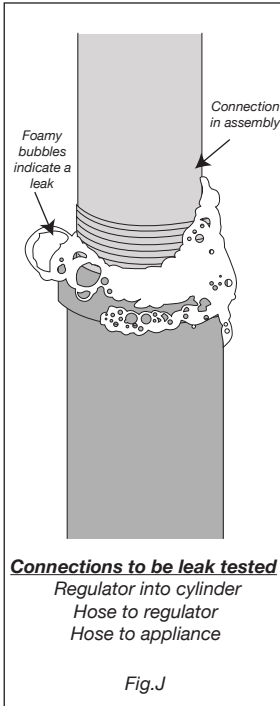

- With the cylinder connected to the heater. Open the cylinder valve.
- Brush the connections (heater to cylinder) with a solution of equal parts soap and water (make sure it's foamy).
- A stream of bubbles forming indicates a gas leak. (See Fig.J)
- If bubbles appear, turn the cylinder valve OFF (clockwise) and disconnect the heater from the gas cylinder.
- Tighten the connection and retry the leak test.
- If you are unsure or if you cannot tighten the connection, place the cylinder outside in a cool, well-ventilated area and contact Alva on **086 100 ALVA (2582)**.
- A leak between the heater and cylinder can lead to a high pressure fire, which is very dangerous and can result in extensive injury or even death.

How to do
a leak test



<http://www.youtube.com/watch?v=8LpZ1B0m23Y&feature=plcp>



**FOR YOUR SAFETY
IF YOU SMELL GAS**

- Turn off the gas supply at the cylinder.
- Extinguish all naked flames.
- **DO NOT** operate any electrical appliances.
- Ventilate the area.
- Check for leaks (see LEAK TEST)
- If odour persists, contact your dealer or local gas supplier immediately.



Before proceeding to ignite the heater, make sure you understand the "IMPORTANT SAFETY INFORMATION" section of this manual.

USING YOUR HEATER

Lighting of the Patio Heater:

1. Depress and turn the control knob clockwise to OFF position.
2. Fully open the gas valve on the cylinder.
3. Depress control knob and turn knob counter-clockwise to IGNITE position, then to PILOT position (You should here a clicking sound).
4. Keep the control knob depressed for 60 seconds, then turn the control knob back to OFF position.
5. Repeat step 3 several times until the pilot ignites.

NOTE: If the pilot light has not ignited, turn the heater control knob to the OFF position, fully close the gas valve, wait 5 minutes, then repeat steps 2-4 of the lighting instructions. If you still experience ignition problems, contact 086 100 ALVA (2582) for assistance.

6. Push in and turn the control knob to LOW position, then release the control knob. If you want a higher temperature, push in the control knob and turn counter-clockwise to the HIGH position.

Turning the Patio Heater Off:

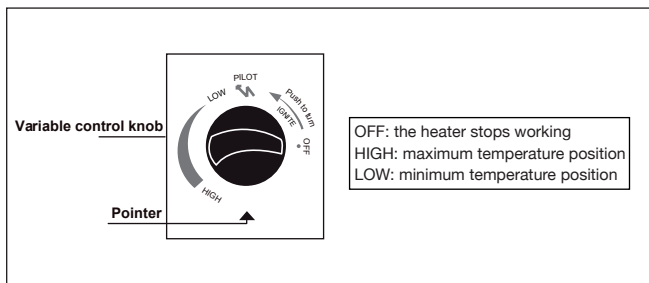

1. Turn the variable control knob to PILOT position.
2. Press and turn the variable control knob to OFF position.
3. Close the cylinder valve (clockwise).
4. DO NOT attempt to relight the heater for at least 10 minutes.



Smoke and odour caused by the heating of oils used during manufacturing will occur when lighting the heater for the first time. This is normal and there is no reason for alarm. Avoid inhaling the fumes!

The smoke and odour should dissipate within 3 - 4 minutes.

Check the heater immediately if any of the following occurs:

- *The heater does not reach temperature.*
- *The burner makes popping noise during use (a slight noise is normal when the burner is extinguished).*
- *Excessive gas smell.*

FLASHBACK (flames in the burner tube)

If a flashback occurs (indicated by a roaring noise), immediately close the cylinder valve.

- Turn the heater OFF at the control knob.
- Disconnect the regulator and allow the heater to cool.
- Check for blockages in the burner head. Clean with compressed air, a small soft brush or pipe cleaners.
- If the problem persists, have the heater checked by a qualified technician.

CHANGING YOUR CYLINDER

Make sure your cylinder valve is closed (by turning it clockwise). Allow the heater to fully cool before replacing the cylinder. Open the heater to expose the cylinder.

Remove and replace the cylinder.

ALWAYS check that the regulator-sealing washer (nose cone) is intact and in place before reattaching the regulator to a cylinder. (Figure B - Page 2)

DO NOT attempt to remove the regulator while the heater is on or if the cylinder valve is not closed.

MAINTENANCE

- Always make sure the heater is OFF and cool, with the cylinder valve closed, before conducting any maintenance.
- Your heater should be checked once a year by a qualified technician.
- If faults are suspected or detected, stop using the heater and contact ALVA.
- Clean the exterior and storage area of your heater when required to remove dust.
- DO NOT use abrasive products to clean the heater; these may damage the paint work.
- Check the burner and remove any debris, dirt, spider webs or wasp nests from the burner ports by using compressed air or a pipe cleaner. DO NOT clean the burner with water or tamper with the jets. If a jet is blocked it must be replaced with an original manufacturer marked jet.
- Replace parts and allow the heater to dry properly before storing.
- If the gas control or ignitor is exposed to water or gets wet, dry it properly before attempting to light the heater. You might have to replace the parts if the heater does not ignite.
- The airflow must not be obstructed. Keep the controls and burner passage clean.

Clean with a soft brush or blow clean with compressed air.

If any part of the heater is in need of replacing, use only original Alva parts. Using any other spare parts is dangerous and will void the warranty.

When the heater is not in use for extended periods, always keep the burner head covered.

Your heater should be checked once a year by a qualified technician. Take special care to retighten any fixtures or nuts and bolts that have come loose.

Signs of a blockage:

1. Heater does not reach the desired temperature
2. Heater making popping sounds
3. Heater 'Flashes back' in burner tube

Cleaning and care

- Wipe off all surfaces with a soft, moist rag. DO NOT clean the heater with combustible or corrosive cleaners.
- Remove debris from the burner to keep it clean and safe for use.

Storage

- Always close the gas valve of the gas cylinder after use or in case of a disturbance.
- Remove the pressure regulator and the hose.
- Check the tightness of the gas valve and for damage. If you suspect damage, have it changed by your gas dealer.
- Never store liquid gas cylinder in a sub-terrain, or at places without adequate air ventilation.

Store the heater in a cool dry place. If in a coastal area extra care must be taken in selecting the storage area as rust will occur if exposed to the elements. Disconnect the cylinder and store separately in a protected dry and cool place.

Alva recommends that you cover your heater.

FREQUENTLY ASKED QUESTIONS

Q: Why is there an odour when I use a gas heater?

A: All gas appliances give off an odour. This could be harmful if inhaled for extended periods of time. This “smell” is normal, and it does not mean that you have a gas leak. The smell of raw gas (just before you ignite the appliance) differs to the smell coming from the heater when it is in use. The odour is added to allow easy gas detection.

Q: Why must there be ventilation when using a gas heater?

A: Whenever fuel (LP Gas in this case) is burned, ventilation is needed. Any fire needs oxygen to burn. Think of a fireplace, you require a chimney or flue for the smoke to exit the house. Even though a gas heater does not generate smoke, it still generates carbon monoxide and carbon dioxide, which can be dangerous if not diluted by fresh air. Always ensure adequate ventilation by leaving a door or window open in the same room.

Q: What do I do if I have an over-filled cylinder?

A: The best method to determine if your cylinder is over-filled is to weigh it. Subtract the ‘tare’ mass from the cylinder weight – this gives you the weight of your gas. If this gas weight exceeds your cylinder design weight (9kg) then return the cylinder to your gas supplier.

Q: How long will the gas in my cylinder last?
A: This depends on how you use your heater. It is easy to calculate your gas consumption. Take the capacity of the gas cylinder in grams (i.e. 9000g for a 9kg cylinder) and divide it by the gas consumption of the heater, on your desired setting (refer to the Technical Data section in this manual (page 16)). The answer to the calculation is the approximate number of hours that your heater will burn for.

TROUBLE SHOOTING GUIDE

Pilot will not light	Gas valve may be OFF	Turn the gas valve ON
	LPG cylinder empty	Refill LPG cylinder
	Jet blocked	Clean or replace jet
	Loose connections	Check all fittings
Pilot will not stay on	Debris around pilot	Clean dirty area
	Loose connections	Tighten connections
	Thermocouple bad	Replace thermocouple
	Gas leak at connections	Check connections
	Low gas pressure	Cylinder near empty Refill LPG Cylinder
Burner will not light	Low gas pressure	Cylinder near empty. Refill LPG tank.
	Jet blocked	Remove, clean or replace
	Control valve not ON	Turn valve to ON
	Thermocouple bad	Replace thermocouple
	Burner not in correct location	Position properly and retry



How to test if your cylinder is overfilled



<http://www.youtube.com/watch?v=Ya-vsYE8nzCw&feature=plcp>

SPECIFICATIONS

Model	ALVA GHP26
Type of Gas	LPG
Operating pressure	2.8kPa
Injector size	1.90mm (Main burner) 0.18mm (Pilot burner)
Gas Consumption	1091gr/hr at MAX
Heat output	15kW
This appliance operates with a Bullnose 5/8" BSP left hand thread with a 2.8kPa SANS 1237 approved 1kg/hr flow rate regulator. Approved SANS1156 hose. Hose and Regulator supplied.	

AFTER SALES SERVICE

MANUFACTURED FOR AND DISTRIBUTED BY ALVA
A division of Stingray Accessory Manufacturers (Pty) Ltd
P.O. Box 30014
Tokai, 7966
Tel: 021 442 1540
E-mail: info@stingray.co.za
www.alva.co.za
@alvagas
www.facebook.com/AlvaGas

TOLL FREE NUMBER **086 100 ALVA (2582)**

***SPARES** are available from our online store
www.stingray.co.za