

ALVA

LOG HEATER

GFP100
GFP101
GFP102



Your world is better with Alva

- This is a low pressure appliance to be used only with a 2.8kpa sans 1237 approved regulator sans 1156 hose (regulator and hose not supplied).
- ^a This heater must be installed by a registered SAQCC installer and in accordance with the requirements of SANS 10087-1.
- For your own safety, please read this manual carefully and always operate this product according to the instructions
- It is illegal and dangerous to change or modify any part of this appliance

Manufactured for
and distributed by

ALVA

A division of Stingray Accessory Manufacturers (Pty) Ltd I PO Box 30014 Tokai 7966 I +27 21 442 1540
info@stingray.co.za I www.alva.co.za **TOLL- FREE NUMBER: 086 100 ALVA (2582)**

 /alvagas

IMPORTANT SAFETY INFORMATION

As with all appliances, misuse of this appliance or failure to fully follow these instructions may cause fire, injury or death. Please read all the instructions before using your heater.

- THIS UNIT MUST BE THOROUGHLY CHECKED BEFORE USE
- Ensure that all the gas fittings are correctly and firmly fitted before every use.
- DO NOT use this heater if you do not clearly understand the instructions and/or how to operate the controls.
- Phone the customer care line at 086 100 ALVA (2582) or email info@stingray.co.za for assistance.
- DO NOT use this heater in an enclosed area, which could restrict airflow.
- This heater must be installed by a registered SAQCC installer and in accordance with the requirements of SANS 10087-1.
- DO NOT operate this heater in a bedroom, caravan, boat or any area less than 80 cubic meters (roughly 5 x 5 metres).
- DO NOT leave the log heater unattended while in use.
- Ensure that the gas supply is turned OFF after use and while the heater is unattended.
- DO NOT move the log heater while in use.
- DO NOT place objects on or against the log heater.
- DO NOT attempt to use the log heater as a stove.
- DO NOT use a naked flame to test for leaks. Follow the Leak-Testing procedure outlined under 'LEAK TEST'.
- NEVER use this heater with a cylinder other than the size recommended.
- DO NOT touch the log heater, as it gets very hot, while in use or after it has been switched off and is cooling.
- DO NOT unscrew the regulator while the heater is on or if the cylinder valve is open.
- DO NOT use a log heater you suspect is faulty.
- When turning the log heater off, first turn the gas off at the control valve (on the heater) and then make sure to close the cylinder valve.
- For safety reasons, only a qualified technician may execute maintenance and repairs. The warranty for the heater will be rendered void if the heater is serviced or repaired by anyone other than an Alva appointed technician.
- The heater should be inspected once a year by a qualified technician, to make sure the unit is safe and fault free.
- The operator is responsible for the safety of all third parties while the heater is in use.



Please read the instructions carefully before use.

Retain this manual for future reference.

This appliance must not be modified in any way - doing so is illegal and will make the appliance unsafe as well as void your warranty.

Do not mount the heater near flammable objects eg: curtains, furniture and carpets.

- Any repairs that need to be done to the heater must be referred to an authorized service agent only.
- This heater is not equipped with a device to control the room temperature. DO NOT use this heater in small rooms when they are occupied by persons not capable of leaving the room on their own, unless supervised.
- Keep away from children.
- Some parts of this product can become very hot and cause burns. Particular attention has to be given where children and vulnerable people are present.

Ensure that children do not play with this heater.

This appliance is not intended or designed for use by persons (including children) with reduced physical, sensory or mental capabilities or lack of experience and knowledge, unless they are supervised or given instruction concerning use of this appliance by a person responsible for their safety.



It is unsafe to position this heater where it is close to combustible material.

Keep combustible materials such as furniture, paper, clothes and curtains at least 1m from the front, sides and rear of the heater.

INDEX

WARRANTY	1
GENERAL INFORMATION	2
METHOD OF ASSEMBLY	2
PARTS VIEW	3
HEATER SETUP	3
LEAK TEST	5
USING YOUR HEATER	5
FLASHBACK	6
CHANGING YOUR CYLINDER	6
MAINTENANCE	6
V	
FREQUENTLY ASKED QUESTIONS	7
SPECIFICATIONS	8
TROUBLESHOOTING	9
TECHNICAL DATA	9
AFTER SALES SERVICE	9

WARRANTY

PLEASE RETAIN YOUR PROOF OF PURCHASE FOR WARRANTY CLAIMS.

ALVA warrants this appliance to be free of defects in material and quality for a period of 12 months from date of original purchase. This warranty covers the intended use of this appliance – within a domestic setting and not for commercial or industrial purposes. Any damage caused by wilful abuse, tampering, modification or unauthorized repair will not be warranted.

Please retain all packaging material, as items returned without original packaging material may be subject to a withholding fee.

Where this appliance is found to be defective, damaged, broken, or does not work correctly for the intended purpose, you must return the appliance to the retailer from where it was purchased. The warranty will only be effected with valid proof of purchase. Failure to provide the proof of purchase will most likely result in the repair or service required being chargeable.

If you have any questions while setting up or using this heater, please visit www.alva.co.za or call 086 100 ALVA (2582) or e-mail info@stingray.co.za

KEY



Important information



Cautions and warnings.



Danger



Contact an approved ALVA technician.



Do It Yourself



Thank you for your purchase of this heater. Please read these instructions carefully before use and keep them in a safe place, for future reference.

GENERAL INFORMATION

Before using this log heater, please read through this manual and make sure you understand everything. If you are not sure, call **086 100 ALVA (2582)** or visit www.alva.co.za for help. This heater is a safe and efficient form of heating when used according to these instructions.

Reading and understanding this manual should give you a good indication of what to expect from your Alva gas log heater. If this product is not what you want or need, please help Alva and the environment by not damaging or destroying any part of the packaging, the manual or the Styrofoam inserts.

Always keep your proof of purchase. Keep these instructions for future use. If you lose this copy, you can obtain a new copy from your dealer or online at www.alva.co.za.



Not using appliances according to the instructions is extremely dangerous and can lead to property damage, injury or death.

For indoor use only. DO NOT use within 1m of any flammable surfaces.

DO NOT store flammable materials near the heater.

METHOD OF ASSEMBLY

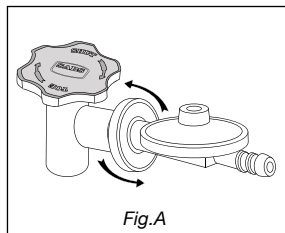

9kg ALVA cylinder recommended with a 5/8" BSP thread; horizontal exit valve. The Bullnose regulator (not supplied with the heater) tightens to the lefthand side (anti-clockwise) (Figure A).

If you have bought a new gas cylinder, the cylinder needs to be purged (cleared out), before its first use. If it is not purged of air, the heater will not work properly. This should happen at the gas filling station when you fill up the cylinder. Always check this with your gas supplier.

WARNING

CARBON MONOXIDE POISONING CAN LEAD TO DEATH

Carbon monoxide poisoning: Early signs of carbon monoxide poisoning resemble flu symptoms, with headaches, dizziness or nausea. If you have these symptoms, the heater may not be working properly. Get fresh air at once! Have the heater serviced. Some people are more affected by carbonmonoxide than others. These include pregnant woman, people with heart or lung disease or anemia, those under the influence of alcohol, and those at high altitudes.

PARTS VIEW

1. body
2. Burner tube
3. control knob
4. Igniter button
5. Inlet connection
6. Pilot flame
7. Flame failure device

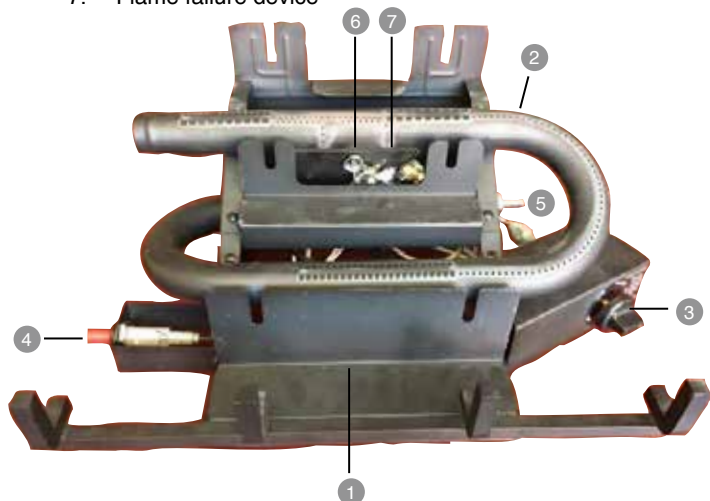

HEATER SET UP

1. Before removing this log heater from the packaging, read this manual in full and make sure that it is what you want/need.
2. Remove the heater from its packaging.
3. Ensure the ceramic logs are not broken
4. The heater must be placed on a level, solid, non-flammable surface. If necessary, it can be fastened to the floor through the 4 mounting holes in the base (mounting screws are not supplied).
5. The bullnose regulator goes directly into the cylinder valve. Always make sure the regulator is pushed fully to the bottom of the cylinder valve before tightening. The use of an adapter is illegal.
6. This heater must be installed by a registered SAQCC installer and in accordance with the requirements of SANS 10087-1.
8. Screw the regulator into the cylinder valve. DO NOT use a tool to tighten the regulator, it is to be hand tightened only.
9. A SANS 1156 hose is to be used. Connect the hose to the regulator and the log heater inlet connection. This hose must be secured to both the regulator and the log heater with hose clamps.
10. Perform the leak test as indicated on page 3. DO NOT try to ignite the log heater when performing this leak test.
11. If no leaks are detected, place the ceramic logs on the heater as indicated below:



Before using the heater, make sure you understand the "IMPORTANT SAFETY INFORMATION" section of this manual.



Take note:
On first lighting a new cylinder or connecting a cylinder after it has been refilled; you may have to depress the control valve for a longer period of time.



Never attempt to remove the Regulator if the heater is on or if the cylinder valve is not properly closed.



Before using the heater, make sure you understand the "IMPORTANT SAFETY INFORMATION" section of this manual.

GFP100

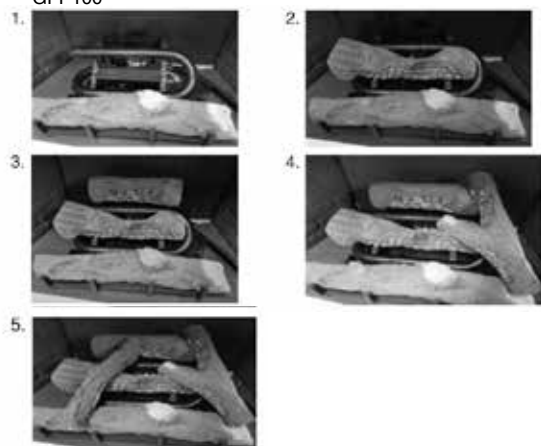

GFP101

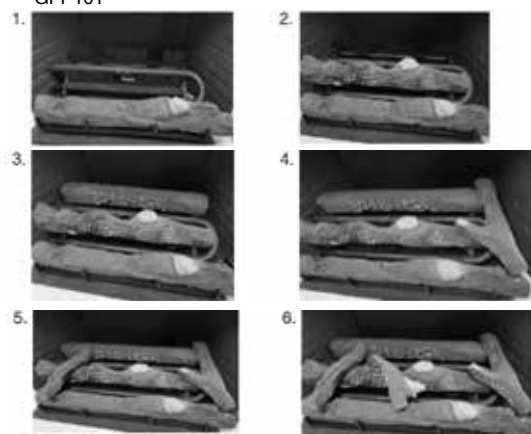

GFP102

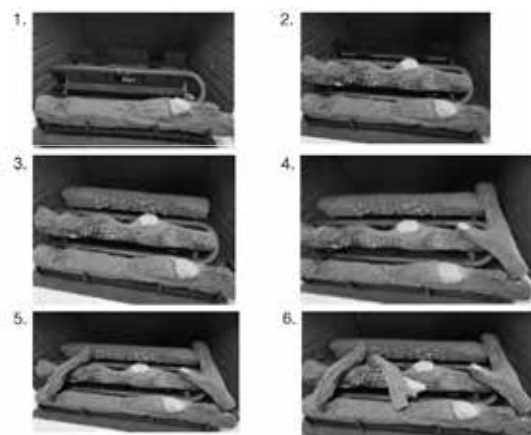

LEAK TEST

The leak test must be carried out in a well-ventilated area, free from any flames or other sources of ignition.

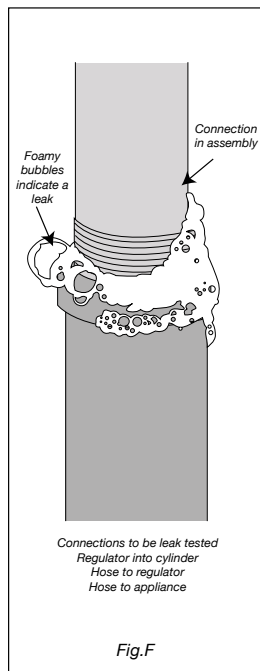

- With the cylinder connected to the heater. Open the cylinder valve.
- Brush the connections (heater to cylinder) with a solution of equal parts soap and water (make sure it's foamy).
- A stream of bubbles forming indicates a gas leak. (See Fig.F)
- If bubbles appear, turn the cylinder valve OFF (clockwise) and disconnect the heater from the gas cylinder.
- Tighten the connection and retry the leak test.
- If you are unsure or if you cannot tighten the connection, place the cylinder outside in a cool, well-ventilated area and contact Alva on **086 100 ALVA (2582)**.
- A leak between the heater and cylinder can lead to a high pressure fire, which is very dangerous and can result in extensive injury or even death.

How to do
a leak test



<http://www.youtube.com/watch?v=8LpZ1B0m23Y&feature=plcp>



**FOR YOUR SAFETY
IF YOU SMELL GAS**

- Turn off the gas supply at the gas cylinder
- Extinguish all naked flames. **DO NOT** operate any electrical appliances.
- Ventilate the area.
- Check for leaks (see LEAK TEST)
- If odour persists, contact your dealer or local gas supplier immediately.

USING YOUR HEATER

This heater can be regulated to two different heat selections:



1. Open the cylinder valve by turning the cylinder valve to the left (anti-clockwise).
2. Press the control knob down at the 'OFF' position. Hold the control knob down for $\pm 10-20$ seconds.
3. While holding it down, turn the control knob anti-clockwise to ignite the pilot flame. Then push the ignitor button, the heater should make a click sound and you should see a spark. The pilot flame should ignite. Once the pilot flame ignites hold down the knob for another $\pm 10-20$ seconds then select your desired setting.
4. If the log heater does not ignite first time, repeat steps 2 and 3 above.
5. This log heater must be turned off using the control knob first, and only then closing the cylinder valve.
6. This heater has a positive off valve. Use the control knob to turn it OFF before closing the cylinder valve.

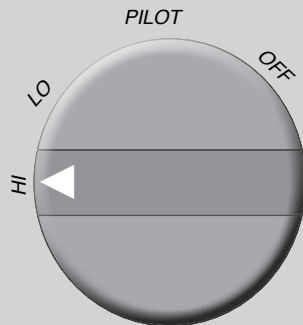

FLASHBACK (flames in the burner tubes)

- If a flash back occurs (indicated by a roaring noise), immediately close the cylinder valve.
- Turn the log heater OFF at the control knob.
- Disconnect the regulator from the gas cylinder and allow the heater to cool.
- Check for blockages in the venturi ports. Clean with compressed air, a small soft brush or pipe cleaners.
- If the problem persists in reuse, have the log heater checked by a qualified technician.

CHANGING YOUR CYLINDER

Make sure the cylinder valve is closed (by turning it clockwise). Allow the log heater to fully cool before replacing the cylinder.

ALWAYS check that the regulator-sealing washer (nose cone) is intact and in place before reattaching the regulator to a cylinder. DO NOT attempt to remove the regulator while the log heater is on or if the cylinder valve is not closed.

MAINTENANCE

Always make sure the heater is OFF and cool, with the cylinder valve closed, before conducting any maintenance.

- Your heater should be checked once a year by a qualified technician.
- If faults are suspected or detected, stop using the heater and contact ALVA.
- Clean the exterior and storage area of your heater when required to remove dust and prevent lint build up.
- DO NOT use abrasive products to clean the heater; these may damage the heater frame and ceramic logs.
- While in operation, the pilot flame should be steady.

If any part of the log heater is in need of replacing, use only original ALVA parts. Using any other spare parts is dangerous and will void the warranty. When the log heater is not going to be used for an extended period of time, keep covered or in its box, to prevent dust from settling on the logs. When removing the heater from storage, use a vacuum cleaner to clean the logs before re-use.



Before using the heater, make sure you understand the "IMPORTANT SAFETY INFORMATION" section of this manual.

FREQUENTLY ASKED QUESTIONS

Q: Why is there an odour when I use a log heater?

A: All gas appliances give off an odour. This could be harmful if inhaled for extended periods of time. This "smell" is normal, and it does not mean that you have a gas leak. The smell of raw gas (just before you ignite the appliance) differs to the smell coming from the heater when it is in use. The odour is added to allow easy gas detection.

Q: Why must there be ventilation when using a gas log heater?

A: Whenever fuel (LP Gas in this case) is burned, ventilation is needed. Any fire needs oxygen to burn. Think of a fireplace, you require a chimney or flue for the smoke to exit the house. Even though a gas heater does not generate smoke, it still generates carbon monoxide and carbon dioxide, which can be dangerous if not diluted by fresh air. Always ensure adequate ventilation by leaving a door or window open in the same room.

Q: How long will the gas in my cylinder last?

A: This depends on how you use your log heater. It is easy to calculate your gas consumption. Take the capacity of the gas cylinder in grams (i.e. 900g for a 9kg cylinder) and divide it by the gas consumption of the log heater, on your desired setting (refer to the specifications section in this manual – page 12). The answer to the calculation is the approximate number of hours that your heater will burn for.

Q: What do I do if I have an over-filled cylinder?

A: The best method to determine if your cylinder is over-filled is to weigh it. Subtract the 'tare' mass from the cylinder weight – this gives you the weight of your gas. If this gas weight exceeds your cylinder design weight (9kg) then return the cylinder to your gas supplier.



*How to test if
your cylinder
is overfilled*



*[http://www.
youtube.com/
watch?v=Ya
vsYE8nzCw
&feature=plcp](http://www.youtube.com/watch?v=YavsYE8nzCw&feature=plcp)*

SPECIFICATIONS

Model	GFP100
Type of Gas	LPG
Operating pressure	2.8kPa
Injector size	1.63mm
Gas consumption	521gr/h
Heat output	7.3kW
This heater has been tested and is LPGSASA approved under Specifications SANS 1539 (appliance).	

Model	GFP101
Type of Gas	LPG
Operating pressure	2.8kPa
Injector size	1.84mm
Gas consumption	658gr/h
Heat output	9.4kW
This heater has been tested and is LPGSASA approved under Specifications SANS 1539 (appliance).	

Model	GFP102
Type of Gas	LPG
Operating pressure	2.8kPa
Injector size	2.01mm
Gas consumption	721gr/h
Heat output	10.3kW
This heater has been tested and is LPGSASA approved under Specifications SANS 1539 (appliance).	

TROUBLESHOOTING

TROUBLE	CAUSE	REMEDY
Odour	Combustion	N/A – the combustion process will always cause an odour
Strong odour	Incorrect gas mixture Unburned gas leak	Obtain LPG only from reputable LPG dealers Perform a leak test. Always ensure there is proper ventilation
Burns then dies	Over-filled cylinder Ventilation Empty cylinder	Return to gas supplier Make sure the room has adequate ventilation Replace with a full cylinder
Heater does not light up	Empty cylinder No gas flow	Replace with a full cylinder Open cylinder valve

FEATURES

Positive off:

The heater can be switched off at the control knob of the unit.

Oxygen Depletion Sensor (ODS)

A safety feature that shuts the heater off if the carbon monoxide levels in the room reach 200 parts per million.

Flame Failure Safety Device:

A safety feature that shuts the gas flow off completely if the pilot flame dies for any reason.

AFTER SALES SERVICE

MANUFACTURED FOR AND DISTRIBUTED BY ALVA,
a division of Stingray Accessory Manufacturers (Pty) Ltd
P.O. Box 30014
Tokai, 7966
Tel: 021 442 1540
E-mail: info@stingray.co.za
www.alva.co.za
 [alvagas](https://www.instagram.com/alvagas)
 www.facebook.com/alvagas

TOLL FREE NUMBER **086 100 ALVA (2582)**



If you are still unable to correct the problem with the information in this guide, then you need to contact your nearest dealer or manufacturer.

Should you experience problems with this gas heater, carry out the necessary checks as per the Trouble Shooting Guide.

If you are still unable to correct the problem with the information in this guide, then you need to contact your nearest dealer or manufacturer.