

ALVA

ELECTRIC FAN HEATER BLACK 2000W

EIH504



Your world is better with Alva

PLEASE READ THESE INSTRUCTIONS CAREFULLY
BEFORE USING THIS APPLIANCE AND RETAIN THIS MANUAL
FOR FUTURE REFERENCE.

As with all electrical appliances, certain care is required for safe use.
This heater is designed to operate safely and provide user comfort.

Failure to read and understand these instructions is dangerous and
can lead to property damage, injury and even death.

This appliance must not be modified in any way - doing so is not legal and will
make the appliance unsafe as well as cancel your warranty.

Manufactured for
and distributed by:

ALVA

A division of Stingray Accessory Manufacturers (Pty) Ltd | P.O. Box 30014,
Tokai, 7966 | +27 21 442 1540 | info@stingray.co.za | www.alva.co.za |
TOLL-FREE NUMBER: 086 100 ALVA (2582)

 /Alvagas

 /alvagas

IMPORTANT SAFETY INFORMATION

As with all appliances, misuse of this appliance or failure to fully follow these instructions may cause fire, injury or death. Please read all the instructions before using your heater.

- Before using this appliance check that the voltage indicated on the type plate corresponds to your mains supply voltage.
- DO NOT use this heater with a programmer, timer or any other device that switches the heater on automatically. There is a fire risk if the heater is covered or positioned incorrectly.
- Always disconnect the heater from the electricity mains when not in use, during installation and cleaning.
- Always ensure that the power cord is kept away from the body of the heater. The heater body will get very hot while in use and can damage the cable.
- Always inspect the power cord for signs of wear or damage. If wear or damage is noted, a suitably qualified person should replace it immediately. Failing to do so is a hazard and may lead to fire and/or electrocution/ electric shock and/or property damage and/or death.
- NEVER allow the cord to come into contact with wet or hot surfaces or become twisted.
- DO NOT damage and DO NOT kink the power cord. DO NOT cover or obstruct the heater when in use. DO NOT insert any objects through any slot or opening in the heater.
- Users must not disassemble the heater, or change/substitute any parts of this heater, if the heater is faulty it is extremely dangerous to use it.
- Keep the heater a distance of at least 1 meter from any combustible material, such as furniture, curtains, bedding, clothes or paper.
Keep the heater clean. DO NOT allow objects to enter the openings, as this may cause electric shock, fire or damage the heater.
- NEVER touch the appliance with wet or damp hands.
- NEVER expose the appliance to atmospheric conditions (rain, sun, etc).
- DO NOT use the appliance for anything other than its intended use.
- DO NOT use this heater in the immediate surroundings of a bath, a shower or a swimming pool.



Please read the instructions carefully before use.

Retain this manual for future reference.

This appliance must not be modified in any way - doing so is illegal and will make the appliance unsafe as well as void your warranty.

- Any repairs that need to be done to the heater must be referred to an authorized service agent only.
- DO NOT connect the appliance to multiple extension cords or multiple outlets.
- This heater is not equipped with a device to control the room temperature. DO NOT use this heater in small rooms when they are occupied by persons not capable of leaving the room on their own, unless supervised.
- This heater must not be located immediately below a socket-outlet.
- Keep away from children.
- Some parts of this product can become very hot and cause burns. Particular attention has to be given where children and vulnerable people are present.

Ensure that children do not play with this heater. This appliance is not intended or designed for use by persons (including children) with reduced physical, sensory or mental capabilities or lack of experience and knowledge, unless they are supervised or given instruction concerning use of this appliance by a person responsible for their safety. If the power supply cord is damaged, it must be replaced with a special cord or assembly, available from the manufacturer or its service agent.



It is unsafe to mount this heater where it is close to combustible materials.

Keep combustible materials such as furniture, paper, clothes and curtains at least 1m from the front, sides and rear of the heater.

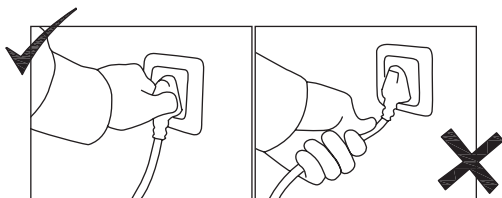

How to unplug your heater correctly

INDEX

WARRANTY	2
GENERAL INFORMATION	2
PARTS DIAGRAM	3
USING YOUR HEATER	4
MAINTENANCE	5
TECHNICAL DATA	6
AFTER SALES SERVICE	6

KEY



Important information



Cautions and warnings.



Danger



*Contact an approved
ALVA technician.*



Do It Yourself

WARRANTY

PLEASE RETAIN YOUR PROOF OF PURCHASE FOR WARRANTY CLAIMS.

ALVA warrants this appliance to be free of defects in material and quality for a period of 12 months from date of original purchase.

This warranty covers the intended use of this appliance - within a domestic setting and not for commercial or industrial purposes. Any damage caused by wilful abuse, tampering, modification or unauthorized repair will not be warranted.

Please retain all packaging material, as items returned without original packaging material may be subject to a withholding fee. Where this appliance is found to be defective, damaged, broken, or does not work correctly for the intended purpose, you must return the appliance to the retailer from where it was purchased. The warranty will only be effected with valid proof of purchase. Failure to provide the proof of purchase will most likely result in the repair or service require being chargeable.

If you have any questions while setting up or using this heater, please call 086 100 ALVA (2582) or e-mail customercare@stingray.co.za

GENERAL INFORMATION

Before using this heater, please read through this manual and make sure you understand everything. If you are not sure, call **086 100 ALVA (2582)** or visit www.alva.co.za for help. This heater is a safe and efficient form of heating when used according to these instructions

Reading and understanding this manual should give you a good indication of what to expect from your Alva heater. If this product is not what you want or need, please help Alva and the environment by not damaging or destroying any part of the packaging, the manual or the Styrofoam inserts.

Always keep your proof of purchase. Keep these instructions for future use. If you lose this copy, you can obtain a new copy from your dealer or online at www.alva.co.za.

ALVA

Thank you for your purchase of this heater. Please read these instructions carefully before use and keep them in a safe place, for future reference.



Not using appliances according to the instructions is extremely dangerous and can lead to property damage, injury or death.

For indoor use only.

DO NOT use within 1m of any flammable surfaces.

DO NOT store flammable materials near the heater.

PARTS DIAGRAM



1	Thermostat switch
2	Heat selected switch
3	Power indicator lights
4	Oscillation switch
5	Air outlet grill



Always ensure that the heater is unplugged when not in use, installing and cleaning.

SELECTION KNOB

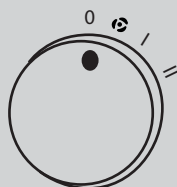

○ INDICATOR LIGHT

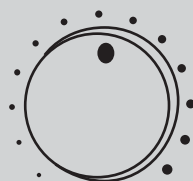

THERMOSTAT KNOB

USING YOUR HEATER

SELECTION KNOB

Before plugging into the wall socket, make sure the thermostat knob is rotated to minimum value and the heat selection switch is at the "O" OFF position.

Note: It is normal when the heaters are turned on for the first time or when they are turned on after having not been used for a long period of time, the heaters may emit some smell and fumes. This will disappear when the heater has been on a short while.

SWITCHING ON

Insert the plug into the wall socket to connect the heater to the electric mains and turn the thermostat switch to the maximum position. Then turn the heat select switch to choose air or warm air and the temperature of warm air as below. While working the indicator light will be on.

SELECTION OF HEATING POWER & OSCILLATION MODES

Choose a suitable location for the heater, taking into account the safety instructions in this booklet.

1. Turn the heat select switch to "  " position, the heater operates as a fan only.
2. Turn the heat select switch to " I " position, the heater blows warm air, working at 1000W.
3. Turn the heat select switch to " II " position, the heater blows warm air, working at 2000W.
4. Turn the heat select switch to " O " position, the heater stops working, the indicator light will be off.
5. Oscillation function: Select " 1 " for oscillation and " 0 " to stop oscillation function.

When the power is on, the power indicator will light up.

TEMPERATURE SETTING

Adjust the thermostat switch to suitable position for desired temperature setting.

1. Check if the thermostat switch is on the maximum position.
2. When you feel the room temperature is comfortable, turn the thermostat switch anti-clockwise slowly to the minimal position until the appliance stops working. Then the thermostat switch will keep the room temperature at the desired temperature automatically.
3. You can also turn the thermostat switch anti-clockwise to the minimum position or turn the thermostat switch clockwise to maximum position to make the temperature lower or higher.

SWITCHING OFF

Place the switch buttons of the selection knob modes to the " O " position and disconnect the appliance from the electric mains.

OPERATION OF THE HEATER

NOTE: It is normal when the heaters are turned on for the first time or when they are turned on after having not been used for a long period of time the heaters may emit some smell and fumes. This will disappear when the heater has been on a short while.



Before using the heater, make sure you understand the "IMPORTANT SAFETY INFORMATION" section of this manual.



The power lamp will be on if the temperature is below the setting of the thermostat.

For maximum benefit, close windows and doors.

Do not cover the ventilation holes as this will cause overheating and will activate the cut out.

OVERHEAT PROTECTION

1. The heater is fitted with an automatic cut out in the event that it overheats. If this activates, turn the heater to the "OFF" position and unplug. Allow the heater to cool and remove anything restricting the airflow before using the heater again. If the automatic cut out operates repeatedly contact a qualified electrician for advice.

TILT SWITCH

1. Should this heater fall over the tilt switch underneath the heater activates and switches it off automatically. Place the heater upright on a stable surface to reset.

MAINTENANCE

It is necessary to periodically wipe the heater, depending on the placement and environment of its use.

1. Wipe surfaces with a soft damp cloth. Do not use detergent or abrasives as this will scratch the surface.
2. Ensure the intake grill is free from dust, as this will reduce the airflow. Light accumulated dust can be removed with soft cloth or vacuum cleaner.
3. Allow surface to fully dry before using the heater again.

Be sure the heater is fault free:

1. Check that the thermostat can be turned ON and OFF. You will hear an audible "click".
 2. Check the electric mains lead is properly connected.
 3. Ensure that the mains lead and plug are not damaged.
- Your heater should be checked once a year by a qualified technician.
 - If faults are suspected or detected, stop using the heater and contact ALVA.
 - Clean the exterior of your heater when required to remove dust.
 - DO NOT use abrasive products to clean the heater, these may damage the heater surface.
 - Always make sure the heater is OFF and cool before conducting any maintenance.
 - Keep young children or infirm persons away from any hot surfaces.
 - Always disconnect the heater from the electricity mains when not in use, during installation and cleaning.
 - DO NOT submerge the heater in water.
 - DO NOT spray down or rinse the heater with water.
 - Maximize the life of your heater:
 - Avoid knocking or scratching the heater.
 - Do not use in dusty environments.
 - When not in use store in clean, cool and dry area.

TECHNICAL DATA

Item number	EIH504
Voltage (V) Hz	220-240V ~ 50-60Hz
Electric power	2000W
Ingress protection	IPX0
Insulation protection	Class II
Heating area	20m ²

AFTER SALES SERVICE

MANUFACTURED FOR AND DISTRIBUTED BY
Alva, a division of Stingray Accessory Manufacturers (Pty) Ltd
P.O. Box 30014
Tokai, 7966
Tel: 021 442 1540
E-mail: customercare@stingray.co.za
www.alva.co.za
 www.facebook.com/AlvaGas

TOLL FREE NUMBER **086 100 ALVA (2582)**