



Casa

ELECTRONIC KITCHEN
WEIGHT SCALE - STAINLESS STEEL

CKSS01



2 x CR2032 Lithium
Batteries included

PLEASE READ THIS MANUAL CAREFULLY
ALWAYS OPERATE THIS PRODUCT ACCORDING TO THE INSTRUCTIONS

CASA (A division of Stingray Accessory Manufacturers (Pty) Ltd
Cape Town, South Africa • Tel: +27 21 442 1540 | 086 100 2582 • Fax: +27 21 448 8033
Email: customercare@stingray.co.za • www.casahome.co.za
www.facebook.com/stingraycasa

INDEX

GLOSSARY OF SYMBOLS FOUND IN THIS MANUAL

DESCRIPTION OF PARTS	2
INTRODUCTION	2
SAFETY INSTRUCTIONS	3
PREPARING THE PRODUCT FOR USE	4
OPERATIONS	4
WEIGHING	4
INCREMENTAL WEIGHING	4
SWITCHING OFF	4
CLEANING AND MAINTENANCE	5
DISPOSAL	5
TROUBLESHOOTING	5
WARRANTY	5
CONTACT US	5



CAUTION



INFORMATION



DANGER

DESCRIPTION OF PARTS

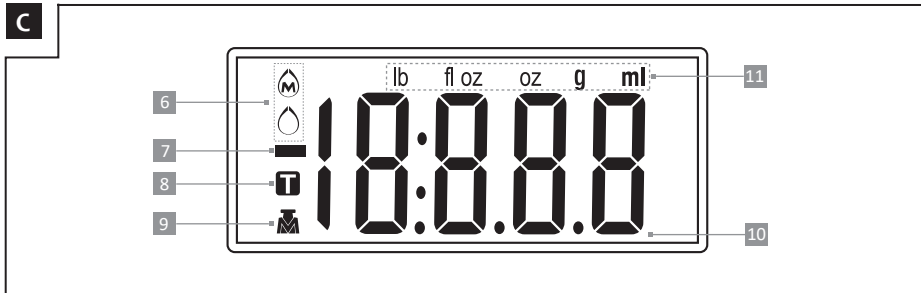
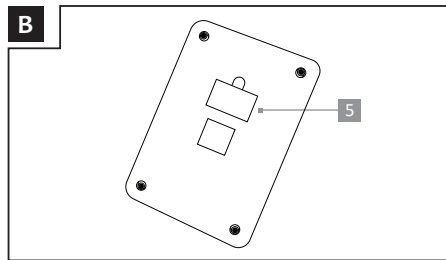
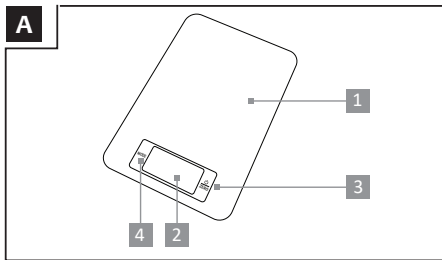

Kitchen scale (Figure A and Figure B):

- 1 Weighing surface
- 2 LCD display
- 3 Button / ZERO
- 4 Button MODE
- 5 Battery compartment

LCD Display (Figure C):

- 6 Fluid type (Water/ Milk)
- 7 Minus symbol
- 8 “TARE” symbol
- 9 “MODE” symbol
- 10 Numerical display
- 11 Unit indicator

INTRODUCTION

Before using the device for the first time, take time to familiarise yourself with the product. In addition, please carefully refer to the operating instructions and the safety advice below. Only use the product as described and for the indicated purpose. Keep these instructions in a safe place. When passing this product on to others, please also include all the documents.

Proper Use

This appliance is designed to weigh and tare food and liquid quantities. The product is for domestic use only and is not intended for medical or commercial use.

Technical data

Max. measuring range	5000 g/ 11 lb:0.5 oz/ 176 oz/ 5000 ml/ 169 fl'oz
Graduation	1g/ 0 lb:0.1 oz/ 0.05 oz/ 1ml/ 0.05 fl'oz
Battery	2 x CR2032 Lithium

Check that all the items are present and that the product and all its parts have no defects immediately after unpacking. DO NOT under any circumstances use the product if the package contents are incomplete.

Includes:

- 1 Kitchen scale
- 2 Batteries (loose)
- 1 Set of instructions for use

SAFETY INSTRUCTIONS



KEEP ALL THE SAFETY ADVICE AND INSTRUCTIONS IN A SAFE PLACE FOR FUTURE REFERENCE!

General Safety Instructions



DANGER OF DEATH AND ACCIDENTS FOR TODDLERS AND CHILDREN!

- Never leave children unsupervised with the packaging material.
The packaging material represents a danger of suffocation. Children frequently underestimate the dangers.
Always keep children away from the packaging material.
- This appliance can be used by children aged from 8 years and above and persons with reduced physical, sensory or mental capabilities or lack of experience and knowledge if they have been given supervision or instruction concerning use of the appliance in a safe way and understand the hazards involved.
- Children may not play with the kitchen scale.
Cleaning and user maintenance may not be made by children without supervision.



CAUTION! DO NOT place more than 5 kg on the scale. This could damage the product.

- Do not expose the product to
 - extreme temperatures,
 - direct sunlight,
 - magnetic fields,
 - moisture.These can damage the product.
- Protect the product from electrostatic charge/ discharge. This could hinder the internal data exchange, which may cause errors in the LCD readout.
- Check the product for damage before use.
Never use a damaged product.
- Magnetic fields may cause the product to malfunction.

If this happens, briefly remove the batteries from the product and re-insert them.



FOOD-SAFE! The taste and smell of your food is not detrimentally affected by this product.

Safety Instructions for the Batteries



CAUTION! DANGER OF EXPLOSION!
THE BATTERIES MUST NEVER BE RECHARGED!

Remove the batteries from the device if it is not going to be used for a prolonged period.

When inserting the batteries, ensure the batteries are used with the correct polarity. This is shown in the battery compartment.

If necessary, clean the batteries and device contacts before inserting the batteries.

Remove the spent batteries immediately from the device. There is an increased danger of leaks!

Keep the batteries away from children; **DO NOT** throw them in the fire, short-circuit them or take them apart.

If the above instructions are not complied with, the batteries may discharge beyond their end voltage. There is then a danger of leaking. If a battery has leaked inside your device, you should remove it immediately in order to prevent damage to the device!



AVOID CONTACT WITH THE SKIN, EYES AND MUCOUS MEMBRANES. ANY PARTS OF THE BODY COMING INTO CONTACT WITH BATTERY ACID SHOULD BE RINSED OFF WITH COPIOUS AMOUNTS OF WATER AND / OR A DOCTOR CONTACTED IF NECESSARY!

PREPARING THE PRODUCT FOR USE

Insert the 2 x CR2032 Lithium batteries supplied into the battery compartment, ensuring the correct polarity.

If the battery is preinstalled, remove protective plastic tab before using the scale.

Replacing the batteries (Figure B)

- Open the battery compartment **5** on the back of the scale.
- Remove the used batteries.
- Insert 2 x CR2032 Lithium batteries in the battery compartment.

Note: Make sure you insert the batteries with the correct polarity.

*This is indicated on the cover of the battery compartment **5**.*

- Never replace just one CR2032 Lithium battery, always replace both at the same time.
- Close the battery compartment.

OPERATION

Set the kitchen scale on a solid, level and surface to weigh.

Weighing

Briefly press the button **ON/ZERO** **3** to switch on the kitchen scale. The LCD **2** will show all displays for approx. 3 seconds. During this time the weighing equipment on the kitchen scale adjusting. Afterwards the numerical display **9** will read "0g". The unit **10** display will show the last unit selected.

Mode and unit:

- Press the MODE button to choose the weighing mode and unit.
- Press and hold the MODE button, the MODE symbol appears and will flash.
- Then press the MODE button to select the weighing mode, the mode will be confirmed after the mode symbol stops flashing.
- After the mode is chosen, you can press the MODE button to choose the weighing unit.
- Total three modes:
 - Mode 1: g/oz/lb :oz
 - Mode 2: water-ml/water-fl:oz
 - Mode 3: milk-ml/milk fl:oz

*Note: if an object (e.g. a key) is already on the weighing surface **1** while switching on, the numerical display will still read "0g".*

Place the item you wish to weigh onto the scale. The numerical display will show the weight of the item you are weighing.

Incremental weighing

Pressing the **ON/ZERO** button **3** with the scale on, will change the numerical display **10** from the reading to "0g". The TARE symbol **8** will appear.

Now add another item to weigh onto the scale. The numerical display will show the weight of the newly added item.

If you remove the item added to the scale, the numerical display will again read "0g".

If you remove all items from the scale, the LCD **2** will show a negative value indicated by the minus sign **7**.

Then briefly press the **ON/ZERO**, and the TARE symbol will disappear.



CAUTION! DO NOT place more than 5 kg on the scale. This could damage the product.

Switching off

Press and hold the **ON/ZERO** **3** button for approximately 3 seconds to turn off the kitchen scale. If no movement is detected on the weighing surface for approximately 2 minutes and no button is pressed, the kitchen scale will automatically switch off.

CLEANING AND MAINTENANCE

Never immerse the product in water or other liquids. This can damage the product. After any plastic part of the scale body is stained with oil, spicy ingredients, vinegar or other stimulating substances, please clean it immediately.

Clean the product with a slightly dampened, fluff free cloth.

To remove more stubborn dirt, you can also dampen the cloth with a weak soap solution.

DISPOSAL



The packaging is made entirely of recyclable materials, which you may dispose of at local recycling facilities.

Contact your local refuse disposal authority for more details of how to dispose of your product.



To help protect the environment, please dispose of the product properly when it has reached the end of its useful life and not in the household waste. Information on collection points and their opening hours can be obtained from your local authority. Return the batteries and / or the device through the special waste collection points available.

Faulty or used batteries must be recycled in accordance with Directive 2006 / 66 /EC. Please return the battery and / or the device to the available collection points.



Environmental damage through incorrect disposal of the battery!

Batteries may not be disposed of with the usual domestic waste. They may contain toxic heavy metals and are subject to hazardous waste treatment rules and regulations. The chemical symbols for heavy metals are as follows:

Cd = cadmium, Hg = mercury, Pb = lead. That is why you should dispose of used batteries at a local collection point.

TROUBLESHOOTING

- **FAULT:** {}{}{}
CAUSE: Scale is overloaded
SOLUTION: Remove the excess load
- **FAULT:** {}{}
CAUSE: Battery is LOW
SOLUTION: Replace the batteries
(see *Replacing the batteries, page 4*)
- **FAULT:** {}
CAUSE: Battery is too weak.
You cannot operate the scale.
SOLUTION: Replace the batteries
(see *Replacing the batteries, page 4*)

WARRANTY

This scale is warranted to be free of defects in workmanship and materials for a period of 1 (one) year from date of purchase. Proof of purchase is required to validate claims, so please retain yours. Before discarding packaging, please ascertain that this product is what is desired. Opening the packaging is considered acceptance that this product is suitable for use.

This scale is for domestic use only (as described in this instruction manual). Any other use should be considered improper and dangerous.

CONTACT US

 **Casa**
A division of Stingray Accessory
Manufacturers (Pty) Ltd
P.O. Box 30014
Tokai
Cape Town
7966

Tel: 086 100 2582 or 021 442 1540
E-mail: customercare@stingray.co.za
www.casahome.co.za
 www.facebook.com/stingraycasa