

PORTABLE BUTANE STOVE



A division of Stingray Accessory Manufacturers (Pty) Ltd

P.O. Box 30014, Tokai, 7966 | +27 21 442 1540 | info@stingray.co.za | www.alva.co.za

TOLL FREE NUMBER: 086 100 ALVA (2582)

PART NAMES



APPROVED FOR USE IN SOUTH AFRICA

FOR USE ONLY WITH
AN EN417 APPROVED
220g BUTANE CANISTER

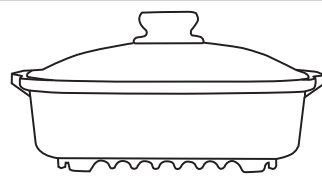
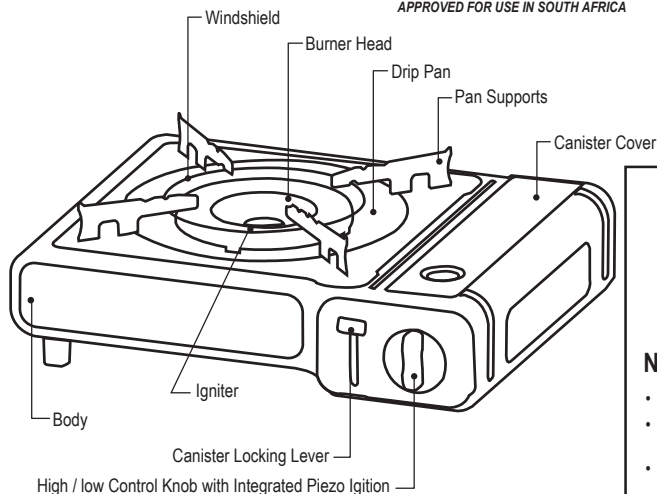

NON-STICK POT AND SURFACE CARE

- LOW TO MEDIUM HEAT RECOMMENDED.
- DO NOT LEAVE EXPOSED TO HIGH HEAT FOR PROLONGED PERIODS OF TIME WHEN EMPTY.
- Excessive and/or prolonged heat to cooking surface can damage the product and surface coating.
- DO NOT USE METAL UTENSILS.
- NOT DISHWASHER SAFE.
- DO NOT USE ABRASIVE COMPOUNDS TO CLEAN.

Metals and abrasive cleaners will scratch and damage the surface coating. Wash only by hand with soapy water.

Important: Read this instruction manual carefully before using.

Familiarize yourself with the appliance before connecting it to the gas canister.

Please keep these instructions for future reference.



WARNING

BEFORE INSERTING A CANISTER, ALWAYS ENSURE THAT THE PAN SUPPORT/DRIP TRAY HAS ALREADY BEEN PLACED UPWARDS IN THE RIGHT POSITION.



CORRECT



UPSIDE DOWN (PACKED)



REMOVED

INSTRUCTION MANUAL

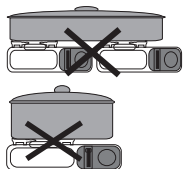

DO NOT USE MULTIPLE APPLIANCES TO HEAT A SINGLE COOKING POT.

DO NOT USE OVERSIZED COOKING POTS (MAXIMUM 27CM DIAMETER).

DO NOT USE THIS APPLIANCE FOR HEATING APPARATUS OR ANY OTHER PURPOSE OTHER THAN COOKING, PLEASE AVOID BOIL OVER AND SPILLAGE.

INSTRUCTIONS FOR OPERATION

1. HOW TO INSTALL CANISTER

- Open canister cover.
- Turn ignition knob to the "O" position and place the canister lever in the "RELEASE" position.
- Install a butane fuel canister, so that the notch on the collar of the canister aligns with the canister guide.
- Press the canister lever down to the "LOAD" position. (The ignition knob must be in the "O" position in order to lock the canister lever.) If gas odour or a hissing sound is detected, do not ignite! Ask your dealer for assistance.

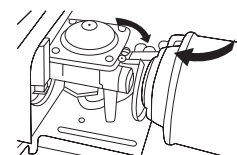
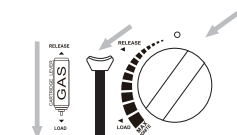
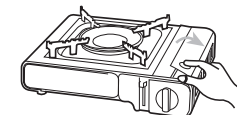

2. HOW TO IGNITE

- Slowly turn the ignition knob 180° anti-clockwise, until you hear a "click" sound.
- This will cause a spark and result in ignition.
- * If there is no flame coming from the burner, return the control knob to the "O" position, wait 30 seconds for the residual gas to dissipate and then attempt to reignite as in point above.

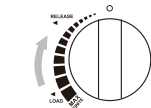
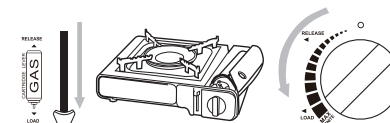

3. FLAME ADJUSTMENT AND SHUT OFF

- To turn down flame rotate control knob clockwise and to turn up flame rotate control knob anti-clockwise.
- To turn off the flame rotate control knob clockwise to the "O" position.
- To remove fuel canister.
 - (1) Verify that the flame is completely extinguished before attempting to remove the butane fuel canister.
 - (2) Raise the canister lever to the "RELEASE" position.
 - (3) Open the canister cover and remove the canister.

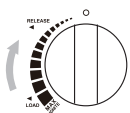
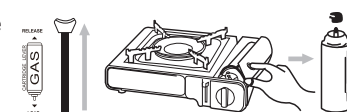

- * **NOTE:** Some fuel may remain in the fuel line of the stove after the stove has been shut off. To eliminate the residual fuel, place canister lever in the "RELEASE" position and turn control knob anti-clockwise for a few seconds and then return the control knob back to "O".

ADDITIONAL WARNINGS

DO NOT STORE OR USE PETROL OR OTHER FLAMMABLES IN THE VICINITY OF THIS OR ANY OTHER APPLIANCE. PROVIDE AMPLE VENTILATION. THIS STOVE CONSUMES OXYGEN. ONLY OPERATE STOVE IN A PROPERLY VENTILATED AREA. TO AVOID ENDANGERING YOUR LIFE, DO NOT USE THIS STOVE IN UNVENTILATED ENVIRONMENTS. PROVIDE ADDITIONAL VENTILATION FOR ANY ADDITIONAL FUEL BURNING APPLIANCES AND ADDITIONAL OCCUPANTS.

FOR YOUR SAFETY

IF YOU SMELL GAS:

1. SHUT OFF STOVE, REMOVE CANISTER.
2. EVACUATE ENCLOSURE.
3. CONTACT ALVA - 086 100 2582.

FOR YOUR SAFETY

DO NOT STORE OR USE PETROL OR ANY OTHER LIQUIDS WITH FLAMMABLE VAPOURS IN THE VICINITY OF THIS STOVE.

SAFETY DEVICE

- This butane stove is equipped with a safety device, which will be activated when there is a fluctuation of gas pressure.
- A safety spring in the governor valve will block the flow of gas and extinguish the flame. An increase of pressure build up could be caused by an overexposure of direct sunlight or excessive heat near the fuel canister.
- If this occurs: shut off stove and remove fuel canister. This stove can't be used again until the fuel canister and butane stove cool down. This stove will not operate until pressure returns to normal.
- **WARNING:** Gas leakage can be detected by either the presence of a distinct odour (like rotten onions), a hissing sound or a combination of both. Shut off the stove immediately! Do not use this stove and return it to the dealer.

CAUTIONS FOR USE

Avoid using during windy conditions. Protect unit from blowing sand, dust and debris.



During operation make sure unit is placed in a stable and horizontal position.



Do not use pots or pans that extend over the edge of the canister cover.



Never use two or more adjacent units to extend the cooking surface.



When in use, always place at least 30cm away from walls and 100cm away from the ceiling.



Do not leave fuel in places where temperature can exceed 40°C. No more than 48 Butane gas fuel canisters shall be stored in one building.



Do not operate stove under a shelf or in an area where there is a danger of falling objects.



Never discard empty canister in fire or incinerator. Consult local sanitation department for disposal information.



BASIC MAINTENANCE

BODY OF STOVE

- After unit has cooled, wash with damp soapy sponge and dry with a cloth. Drip pan can be removed for baked on debris.

BURNER HEAD

- Do not allow portholes to become clogged. Use a wire brush to remove debris from portholes on the burner.

IGNITION PLUG

- Do not let the ignitor become moist, otherwise it will not work properly.

TROUBLE SHOOTING

TROUBLE CAUSES	TROUBLE SHOOTING						
	UNABLE TO INSTALL CANISTER.	NO GAS SUPPLY IN "ON" POSITION.	SMELL GAS IN "OFF" POSITION.	LOW FLAME.	UNEVEN FLAME.	NO IGNITION/ FAULTY IGNITION.	EXTINCTION IN OPERATION.
IGNITION KNOB NOT IN "OFF" POSITION.	○						TURN IGNITION KNOR COMPLETELY TO "OFF" AND RESET CANISTER.
PRESSURE SENSOR IN REGULATOR VALVE ACTIVATED.		○				○	○ REFER TO EXPLANATION FOR PRESSURE DEVICE.
IGNITION KNOB MALFUNCTION.		○	○	○		○	CONTACT LOCAL AGENT TO REPAIR.
CLOGGED VALVE NOZZLE.		○		○		○	CONTACT LOCAL AGENT TO REPAIR.
CANISTER INCORRECTLY INSTALLED.	○	○	○			○	FIT CANISTER NOTCH INTO CANISTER GUIDE.
CLOGGED BURNER HOLES.				○	○	○	USE A METAL BRUSH TO CLEAN IT.
BENT OR ENCRUSTED ELECTRODE.						○	REMOVE DIRT.
NO GAS.		○		○	○	○	○ REPLACE FUEL CANISTER.

SPECIFICATIONS

Model	CCR101	M
Gas	Butane gas	
Injector size	0.56mm	
Gas consumption at Max	168gr/hr	
Heat input	2.5kW	
Heat efficiency	58%	
Operating pressure	Canister Vapour	

TROUBLE SHOOTING

CAUSES	SOLUTIONS
Ignition knob is not turned to "MAX" position	Turn ignition knob completely to "OFF" and reset cartridge
Safety Device Activated	Refer to explanation for Auto Safety Device
Ignition Knob malfunction	Contact 086 100 ALVA (2582)
Clogged nozzle	Contact 086 100 ALVA (2582)
Cartridge incorrectly installed	Fit cartridge guide into cartridge slot
Clogged burner holes	Clean with a metal brush
Bent or rusty electrode	Clean electrode
No gas	Replace Butane cartridge

WARRANTY

PLEASE RETAIN YOUR PROOF OF PURCHASE FOR WARRANTY CLAIMS.

ALVA warrants this appliance to be free of defects in material and quality for a period of 12 months from date of original purchase. This warranty covers the intended use of this appliance – within a domestic setting and not for commercial or industrial purposes. Any damage caused by willful abuse, tampering, modification or unauthorized repair will not be warranted. Please retain all packaging material, as items returned without original packaging material may be subject to a withholding fee. Where this appliance is found to be defective, damaged, broken, or does not work correctly for the intended purpose, you must return the appliance to the retailer from where it was purchased. The warranty will only be effected with valid proof of purchase. Failure to provide the proof of purchase will most likely result in the repair or service required being chargeable.

If you have any questions while setting up or using this cooker, please visit www.alva.co.za or call Toll Free **086 100 ALVA (2582)** or e-mail info@stingray.co.za.