

ALVRAIR

92cm TOWER FAN

ACS206



PLEASE READ THESE INSTRUCTIONS CAREFULLY
BEFORE USING THIS APPLIANCE AND RETAIN THIS MANUAL
FOR FUTURE REFERENCE.

As with all electrical appliances, certain care is required for safe use.
This air cooler is designed to operate safely and provide user comfort.

Failure to read and understand these instructions is dangerous and
can lead to property damage, injury and even death.

This appliance must not be modified in any way - doing so is illegal and
it will render the appliance unsafe and void your warranty.

Manufactured for
and distributed by:

ALVRAIR

A division of Stingray Accessory Manufacturers (Pty) Ltd | P.O. Box 30014, Tokai, 7966
+27 21 442 1540 | info@stingray.co.za | www.alva.co.za
TOLL FREE NUMBER: 086 100 ALVA (2582)

 /AlvaGas

IMPORTANT SAFETY INFORMATION

- Please read these instructions carefully before using your Tower Fan. The operator must understand all safety requirements as detailed in this manual before using the unit.
- The manufacturer's warranty may be voided by incorrect use of this product. If you have any queries regarding these instructions, contact your local dealer for clarification before using your Tower Fan.
- Always remove unit from all packaging materials prior to use.
- Failure to follow the manual's instructions could result in damage or serious injury.
- When using electrical appliances, in order to reduce the risk of fire, electric shock, and/or injury, these basic safety precautions should always be followed.
- This product is intended for general domestic use to cool rooms and is not intended for use in windows.
- Do not use the product for any other purpose.
- Keep the product out of the reach of children and pets. This product is not intended for use by children.
- Do not leave the product unattended while it is in use, especially when children are present. Always unplug the product from the electrical outlet when it is not in use.
- Always operate the product on a flat, level, steady and stable surface to avoid it overturning.
- Do not hang or wall-mount the product.
- Do not place the product in or near an open window. Rain, snow, and other weather elements may create an electrical hazard.
- Keep the power cord and product away from sharp edges and heated surfaces.
- Always unplug the product from the electrical outlet when cleaning it.

Thank you for your purchase of this Tower Fan, Please read these instructions carefully before use and keep them in a safe place, for future reference.



WARNING:
TO AVOID THE RISK OF ELECTRICAL SHOCK, ALWAYS MAKE SURE THE PRODUCT IS UNPLUGGED FROM THE ELECTRICAL OUTLET BEFORE ASSEMBLING, DISASSEMBLING, RELOCATING, SERVICING, OR CLEANING.

For indoor use only.



Assembly required

- Do not plug/unplug the product into/from the electrical outlet with a wet hand. Never insert fingers or any other object through the fan guards. Never drop or insert objects into any opening of the product.
- Do not attempt to open any part of the motor housing, as a risk of electrical shock may exist.
- Never operate the product without the fan guards in place, as serious personal injury may result. Plug the product into a standard outlet.
- Do not allow the power cord to hang (i.e., over the edge of a table or counter) where it may be tripped over or pulled.
- Do not operate product if the power cord is cut, damaged, or if the wires are exposed. Contact 086 100 ALVA (2582) or an Authorised Service agent to replace the power cord.
- Do not immerse or expose the motor housing, power cord, or plug into water or other liquids. Disconnect the plug (do not pull on the power cord) from the electrical outlet.
- Do not put any stress on the power cord where it connects to the product, as the power cord could fray and break.
- Do not operate the product if it has a damaged power cord or plug, malfunctions, is dropped, or damaged. This product has no user-serviceable parts.
- Do not attempt to examine or repair this product yourself. Qualified service personnel should perform any servicing. This product is intended for indoor, non-commercial, non-industrial, household use only.
- Do not use outdoors. This appliance is not intended for use by persons (including children) with reduced physical, sensory or mental capabilities or lack of experience and knowledge, unless they have been given supervision or instruction concerning use of the appliance by a person responsible for their safety.

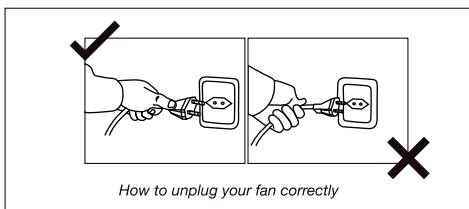

How to unplug your fan correctly

To remove from the socket pull the plug, not the electrical cord

WARRANTY

PLEASE RETAIN YOUR PROOF OF PURCHASE FOR WARRANTY CLAIMS.

ALVA warrants this appliance to be free of defects in material and quality for a period of 12 months from date of original purchase. This warranty covers the intended use of this appliance – within a domestic setting and not for commercial or industrial purposes. Any damage caused by willful abuse, tampering, modification or unauthorized repair will not be warranted.

Please retain all packaging material, as items returned without original packaging material may be subject to a withholding fee. Where this appliance is found to be defective, damaged, broken, or does not work correctly for the intended purpose, you must return the appliance to the retailer from where it was purchased.

The warranty will only be effected with valid proof of purchase. Failure to provide the proof of purchase will most likely result in the repair or service required being chargeable.

If you have any questions while setting up or using this Tower Fan, please visit www.alva.co.za or call 086 100 ALVA (2582) or e-mail info@stingray.co.za

GENERAL INFORMATION

Before using this Tower Fan, please read through this manual and make sure you understand everything. If you are not sure, call **086 100 ALVA (2582)** or visit www.alva.co.za for help.

Reading and understanding this manual should give you a good indication of what to expect from your Tower Fan.

Always keep your proof of purchase. Keep these instructions for future use.

If you lose this copy, you can obtain a new copy from your dealer or online at www.alva.co.za.

INDEX

PARTS LIST	2
ASSEMBLING THE FAN	3
OPERATING THE FAN	4
REMOTE CONTROL BATTERY REPLACEMENT	5
CLEANING AND MAINTENANCE	6
DISPOSAL	6
TROUBLE SHOOTING	7
SPECIFICATIONS	7
AFTER SALES SERVICE	7

KEY

Notes marked with the following;



Contain important information

Notes marked with the following;



Contain cautions and warnings.

PARTS LIST

1.	Body
2.	Holder
3.	Timer
4.	Speed
5.	Mode
6.	Oscillation

7.	ON/OFF
8.	Power Plug
9.	Stand
10.	Screws
11.	Remote Control

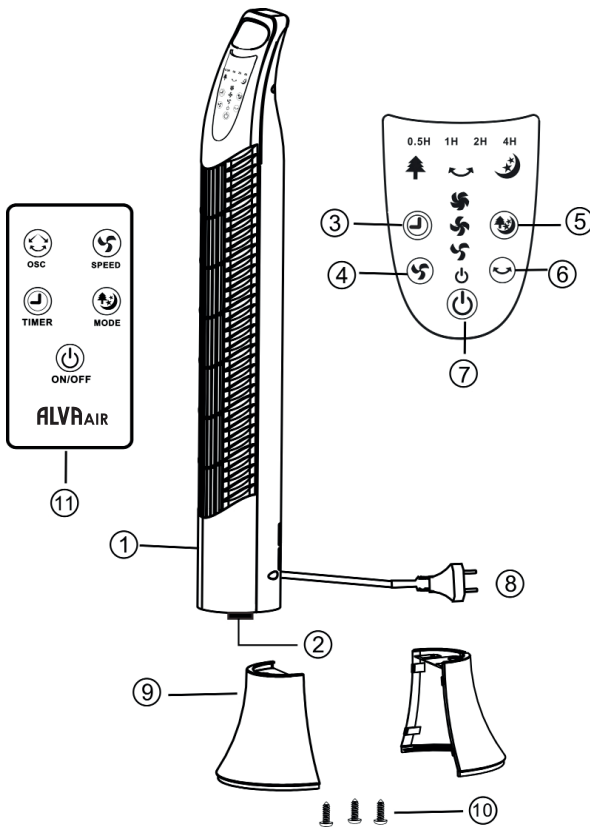

Assembly required

ASSEMBLING THE FAN

1. Remove all of the appliance parts out of the packaging
2. Place the fan upside down so that you can see the Holder (2) underneath. Remove the 3 Silver screws (Fig.1).
3. Press the Stand (9), parts 1 and 2 (Fig.2) together. You will know when assembled properly as they clip together.
4. Place the power cord through the outlet in the Stand (9). (Fig.3)
5. Place the stand onto the bottom of the fan and fasten with the 3 silver screws. (Fig.4)

(Fig.1)

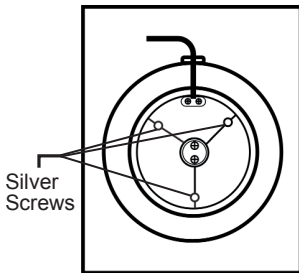

(Fig.2)

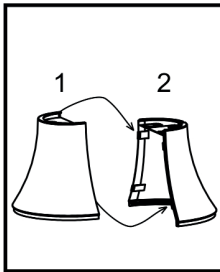

(Fig.3)



(Fig.4)

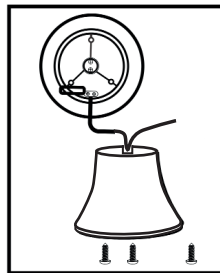

OPERATING THE FAN

All the functions below can be performed on the fan touch control panel, or by using the remote control. The remote control has a direct line of sight range of approximately 6m.

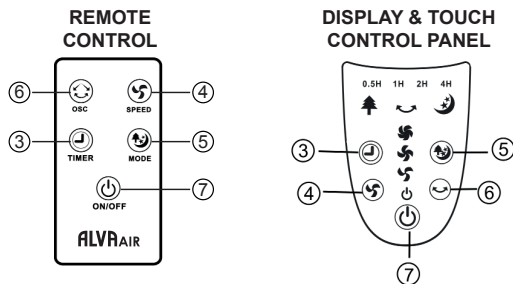

POWER

- Press the ON/OFF (7) button, to select power on or off.

SPEED

- Press the ON/OFF (7) button, to power on the fan.
- Press the speed button (4) to select the fan speed.
- 3 speeds: (Low - Medium - High)
- The selected speed is indicated on the fan display panel.

OSCILLATION

- Press the ON/OFF (7) button, to power on the fan.
- Press the Oscillation button (6), to select oscillation, the indicator light on the fan display panel will illuminate.
- To stop oscillation press the button again.

TIMER (0.5 - 7.5 HOURS)

- Press the ON/OFF (7) button, to power on the fan.
- Press the TIMER (3) button, to the desired time period (0.5-7.5 Hours)
- The selected time is indicated on the fan display panel. For example, if you have set the timer for 3.5 hours, the 0.5H, 1H and 2H lights will be illuminated.
- It will now remain operating until the selected time period is reached.
- Fan then switches off automatically.
- When all the timer lights are off, it means that the time is not set and the unit will operate continuously until you switch it off manually.

MODE

- Press the ON/OFF (7) button, to power on the fan. The fan will operate in Normal mode. The set speed will operate continuously. There is no light to indicate Normal mode.
- Press the MODE button (5), to select the fan mode.
- 3 modes: (NORMAL / NATURE / SLEEP).
- The default mode is NORMAL, and the NATURE /SLEEP mode will be indicated on the control panel when selected: NATURE / SLEEP .

Please read these instructions carefully before use and keep them in a safe place for future reference.



Before using the remote control, remove the clear plastic protector protruding from the battery compartment of the remote control.

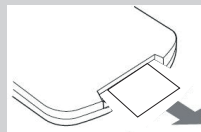

Normal mode, the fan operates at the set speed continuously.
 Nature mode, the fan speed varies during operation, see charts below.

NATURE MODE: OPERATING CYCLE

 High Speed Setting

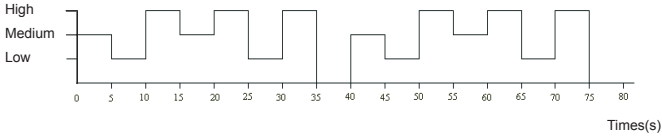

 Medium Speed Setting

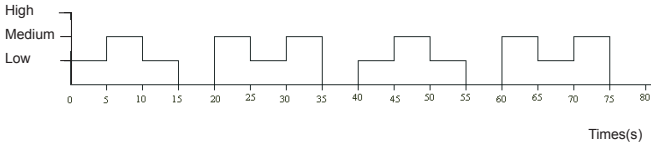

 Low Speed Setting

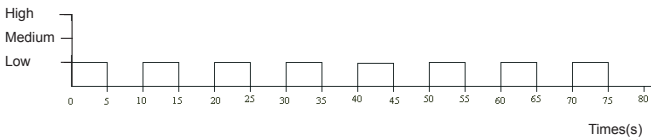

Sleep mode, the fan speed steps down after half an hour until it settles at low speed continuously.

SLEEP MODE: OPERATING CYCLE



REMOTE CONTROL BATTERY REPLACEMENT

Inserting batteries into the remote control

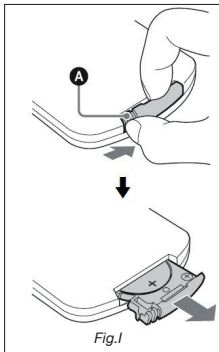

Remove the battery cover from the back of the unit and insert the batteries in accordance with the polarity of the batteries . (Fig1)

Replace the old batteries with the same type of batteries or the Tower Fan function may be impaired.

Remove the batteries before long periods of non-use to prevent leakage which will damage the remote control.



*Replacement
 Battery
 CR2025*

*Available from
 www.stingray.co.za*

CLEANING AND MAINTENANCE

- The appliance, the power cord and the power plug must not be immersed in water or other liquids when you are cleaning them. Clean them with a dry cloth.
- If it is very dirty, the outside of the appliance can be wiped carefully with a damp cloth and then dried. Make sure that no moisture penetrates into the interior of the appliance.
- Do not use any harsh cleaners, steel brushes, scouring powder or other hard objects to clean the appliance as these can cause scratches on the surfaces.
- Clean the appliance regularly.
- Never use solvents, benzene or oil-based cleaners as these can damage the housing.
- Re-tighten visible screw connections on the appliance regularly in order to ensure that the device is functioning properly.

DISPOSAL

Used electric household devices:

1. If you do not want to use your electrical appliance any longer, dispose of it at a recycling depot for used electric appliances.
2. Used electric devices must not be disposed of with normal household rubbish.

Further disposal instructions:

1. Return the electrical appliance in such a condition that its later re-use or recycling is not adversely affected.
2. Batteries must be removed in advance and the destruction of parts which contain fluids must be avoided.
3. Electrical appliances can contain harmful substances. Improper handling or damage to the appliance can lead to health problems or water or ground contamination, when the appliance is recycled later.



Before cleaning the fan always remove the plug from the power socket to prevent injury or electrical shock



TROUBLE SHOOTING

If the Tower Fan will not operate	Confirm the Tower Fan switch is not in the off position
	Check the Tower Fan is plugged into the wall socket and wall socket is switched on.
Remote control not working	Make sure nothing is between you and the fan
	Hold remote control directly in front of fan
	Replace battery

SPECIFICATIONS

Model	ACS206
Description	92cm Tower Fan
Voltage	220 - 240V ~ 50Hz
Input Power	40W
Any modification to the Tower Fan may cause injury or property damage.	
Any modification to the Tower Fan will invalidate the warranty on this appliance.	

AFTER SALES SERVICE

MANUFACTURED FOR AND DISTRIBUTED BY ALVA MARKETING
Alva Air, a division of Stingray Accessory Manufacturers
(Pty) Ltd.

P.O. Box 30014

Tokai, 7966

Tel: 021 442 1540

E-mail: info@stingray.co.za

www.alva.co.za

 www.facebook.com/AlvaGas

TOLL FREE NUMBER

086 100 ALVA (2582)



Should you experience problems with this Tower Fan, carry out the necessary checks as per the Trouble Shooting Guide.

If you are still unable to correct the problem with the information in this guide, contact your nearest dealer or ALVA: 086 100 (ALVA) (2582) or e-mail info@stingray.co.za