

ALVA

EVAPORATIVE TWIN FAN AIR COOLER

ACS101



PLEASE READ THESE INSTRUCTIONS CAREFULLY
BEFORE USING THIS APPLIANCE AND RETAIN THIS MANUAL
FOR FUTURE REFERENCE.

As with all electrical appliances, certain care is required for safe use.
This air cooler is designed to operate safely and provide user comfort.

Failure to read and understand these instructions is dangerous and
can lead to property damage, injury and even death.

This appliance must not be modified in any way - doing so is illegal and
it will render the appliance unsafe and void your warranty.

Manufactured for
and Distributed by:

ALVAAIR

A division of Stingray Accessory Manufacturers (Pty) Ltd | P.O. Box 30014, Tokai, 7966
+27 21 442 1540 | info@stingray.co.za | www.alva.co.za
TOLL FREE NUMBER: 086 100 ALVA (2582)

IMPORTANT SAFETY INFORMATION

As with all appliances, misuse of this appliance or failure to fully follow these instructions may cause fire, injury or death. Please read all the instructions before using your air cooler. If you have any doubt or concerns about this appliance's installation, please consult a qualified electrician.

Make sure your electricity supply is 220-240V~50Hz
Use the appliance only as described in the manual. Other uses are not recommended as it may cause fire or electric shock.

Do not use the unit in areas where extreme temperatures occur,
Do not expose the unit to direct sunlight. For indoor use only.
Do not fill water over the Max level in the water tank.
Do not move the air cooler quickly if there is water inside the water tank to avoid water spillage.
Do not place the unit near any explosives, heated or hot surfaces.

Hold the plug to disconnect from the power socket.
Do not pull the power cord only.
Do not use the "Cooler" function in an enclosed area with poor ventilation for a extended periods to avoid high humidity.
The unit must be operated on a flat, sturdy hard surface/floor.
Close supervision is required when the appliance is used by or near children.

Put the power OFF and unplug from the outlet before cleaning.
If the unit will not be used for a long time, please unplug the unit and drain all the water inside the tank.

Change the water regularly to keep the water clean.
Do not immerse the unit, power cord or plug in water.
Do not fill the water tank above the "Max" level.
Do not move the water tank quickly if it still contains water to avoid spillage.

NOTE: To avoid danger of electric shock, unplug from the power outlet when not in use and before cleaning.
If the supply cord is damaged, stop using immediately and bring it to the service centre for the repair.



Please read the instructions carefully before use.

Retain this manual for future reference.

This appliance must not be modified in any way - doing so is illegal and will make the appliance unsafe and void your warranty.

- Only an authorised Service Agent can effect repairs to the air cooler.
- Any repairs that need to be done to the air cooler must be referred to an authorized service agent only.
- DO NOT connect the appliance to multiple extension cords or multiple outlets.
- Keep away from children.
- Particular attention has to be given where children and vulnerable people are present.

Ensure that children do not play with this air cooler. (This appliance is not intended or designed for use by persons (including children) with reduced physical, sensory or mental capabilities or lack of experience and knowledge, unless they are supervised or given instruction concerning the use of this appliance by a person responsible for their safety.)

If the power supply cord is damaged, it must be replaced with a special cord or assembly, available from the manufacturer or its service agent.



To avoid danger of electric shock, unplug from the outlet before cleaning,

If the electrical cord is damaged, stop using immediately and contact our customer care for a repair.

Customer Care

086 100 ALVA (2582)

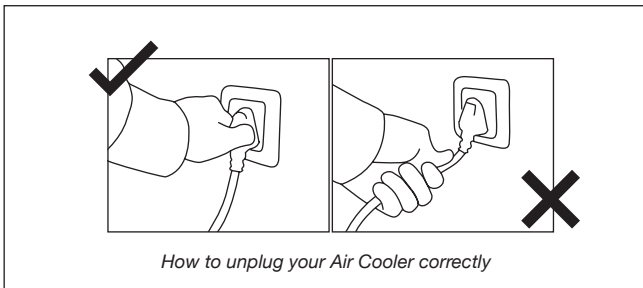

How to unplug your Air Cooler correctly

To remove from the socket pull on the plug, not the electrical cord

INDEX

WARRANTY	2
GENERAL INFORMATION	2
FEATURES DIAGRAM	3
INSTALLATION	4
REMOTE CONTROL	4
OPERATION INSTRUCTIONS	5
MAINTENANCE	6
STORAGE	7
TROUBLESHOOTING	7
TECHNICAL DATA	8
AFTER SALES SERVICE	8

KEY



Important information



Cautions and warnings.



Danger

ALVA

*Customer Care
086 100 ALVA (2582)*



No assembly required

WARRANTY

PLEASE RETAIN YOUR PROOF OF PURCHASE FOR WARRANTY CLAIMS.

ALVA warrants this appliance to be free of defects in material and quality for a period of 12 months from date of original purchase. This warranty covers the intended use of this appliance – within a domestic setting and not for commercial or industrial purposes. Any damage caused by willful abuse, tampering, modification or unauthorized repair will not be warranted. Please retain all packaging material, as items returned without original packaging material will be subject to a handling fee.

Where this appliance is found to be defective, damaged, broken or does not work correctly for the intended purpose, you must return the appliance to the retailer from where it was purchased. The warranty will only be effected with valid proof of purchase. Failure to provide the proof of purchase will most likely result in the repair or service required being charged.

If you have any questions while setting up or using this air cooler, please visit www.alva.co.za or call 086 100 ALVA (2582) or e-mail info@stingray.co.za

GENERAL INFORMATION

Before using this air cooler, please read through this manual and make sure you understand it. If you are not sure, call **086 100 ALVA (2582)** or visit www.alva.co.za for help. This air cooler is a safe and efficient form of cooling when used according to these instructions.

Reading and understanding this manual should give you a good indication of what to expect from your Alva air cooler. If this product is not what you want or need, please help Alva and the environment by not damaging or destroying any part of the packaging, the manual or the Styrofoam inserts. Always keep your proof of purchase. Keep these instructions for future use. If you lose this copy, you can obtain a new copy from your dealer or online at www.alva.co.za.

ALVA

Thank you for your purchase of this Air Cooler. Please read these instructions carefully before use and keep them in a safe place, for future reference.



Not using appliances according to the instructions is extremely dangerous and can lead to property damage, injury or death.

For indoor use only.

FEATURES DIAGRAM

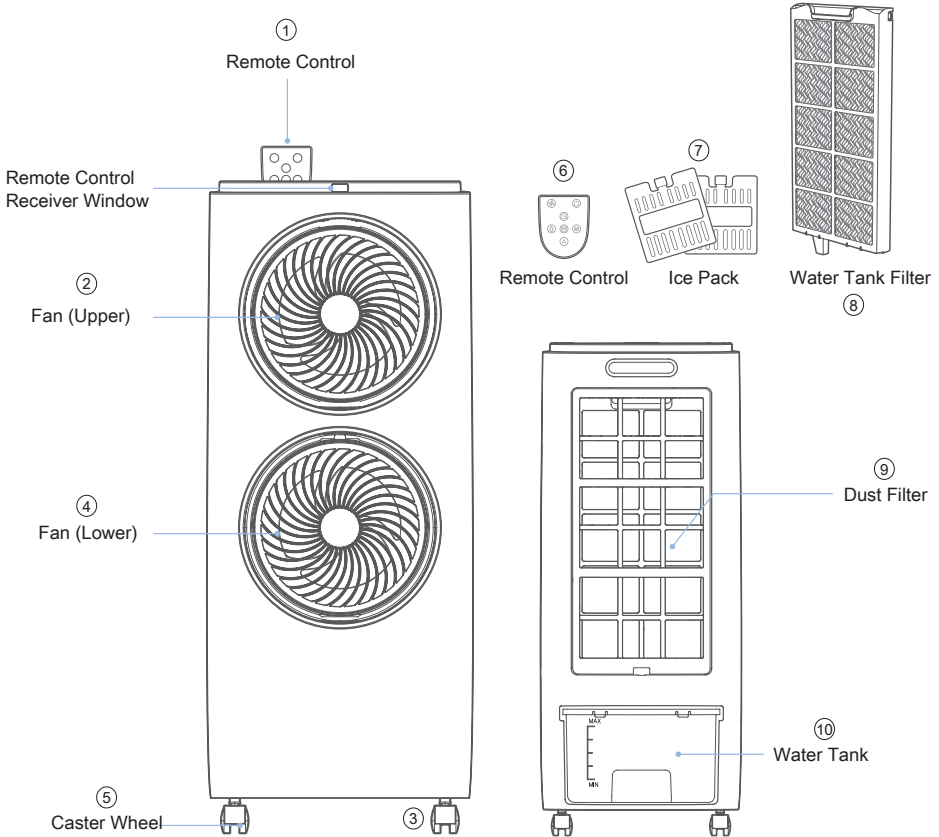

1	Remote Control Holder	x 1	6	Remote Control	x 1
2	Fan - Upper	x 1	7	Ice Pack	x 2
3	Foot Holder	x 1	8	Water Filter Panel	x 1
4	Fan Lower	x 1	9	Dust Filter	x 1
5	Caster wheels	x 2	10	Water Tank	x 1

INSTALLATION

Open carton and remove the Air Cooler

Make sure there is enough space to place all parts before starting assembly, It is necessary to pull out the tank to fill the water.

Fill the water tank with clean water to the "Max" level indicated on the tank. Close the water tank and remove any spillage with a dry cloth.

If any difficulty is experienced placing the water tank in its correct position. please read the cleaning and maintenance section of this manual. Ice cubes or ice packs can be placed in the water tank.

Please fill the water tank before using the Cool Air Function. If the water is at a low level mark, the Cool Air function will not be activated until the tank is refilled.

The unit can be used without water as a normal electrical fan. Please keep the "COOLER" button on OFF mode during humid weather. Place the ice cubes or ice packs into the water tank to lower the water temperature and increase cool air function.

NOTE:

Do not place ice cubes into the water tank when it is full, as the water may overflow.

The ice packs should be frozen 2-3 hours before use

The ice pack is sealed, Please do not try to open it.



Before using the air cooler make sure you understand the "IMPORTANT SAFETY INFORMATION" section of this manual.

REMOTE AND CONTROL PANEL

Fig A

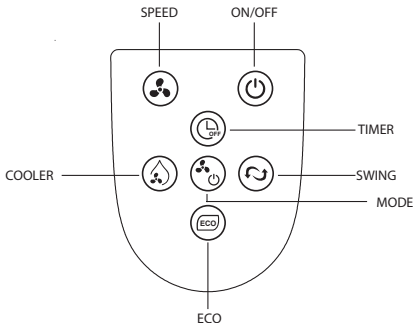
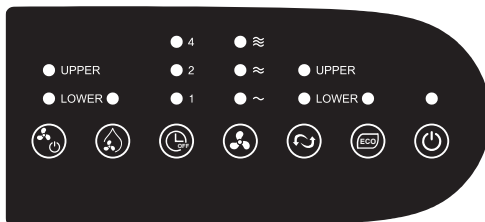

Fig B



OPERATION INSTRUCTIONS

The unit is designed for indoor household use only.

Ambient Temperature	Speed
Above 35° C	High
28 C ~ 34° C	Medium Wind
Below 27° C	Low



ON/OFF BUTTON

Press the ON/OFF button, the indicator light will illuminate
Press the ON/OFF button again to turn off the unit



ECO BUTTON

Automatically adjusts the fan speed according to the rooms ambient temperature, The LED indicator will illuminate when it is operational.



SWING FUNCTION

Press the button once, the upper and lower LED lights will be illuminate, the two fan blades will meet in the same direction. Pressing the button once causes both fans to swing together in unison. Pressing the button once causes both fans to swing in the opposite directions to each other. Pressing it again activates only the upper fan swing function. Pressing it again activates only the lower fan swing function.



SPEED BUTTON

Press the Speed button to select 3 different fan speeds
Press “LO~” lights up for Low fan speed
Press “MI~” lights up Medium fan speed
Press “HI~” lights up High fan speed



TIMER BUTTON

Press the timer button to set the length of operation from 1 to 7 hours in the increments of 1 hour, 2 hours, 4 hours.
Press the timer button once to change the setting to the next time zone. The unit works continuously if no time indicator light is displayed.



COOLER BUTTON

Press the cool air button, the cool function is illuminated and the unit will start to circulate water. Air blowing through the fan will now be cooler by circulating water. When there is no water in the water tank, the LED Indicator will turn red, and a beeping sound will be heard. Refill the water tank with cold water.



MODE BUTTON

Pressing the mode button, the upper and lower fans start working, and the LED indicator lights up. Please place the remote control in the recess area and turn on the automatic function. The effect may not be ideal when the fan is working from a distance or close obstacles.

MAINTENANCE

To extend the product life and maintain best performance, it is recommended that you clean the air cooler regularly.

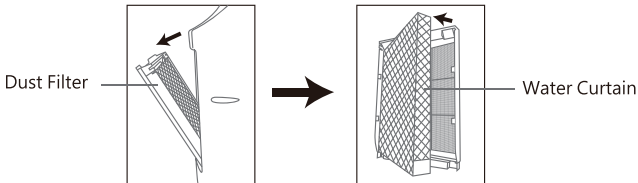

General Cleaning

Do not use gasoline, thinners, solvents, ammonias or other chemicals for cleaning and maintenance.

Filter Cleaning

Remove the filter carefully and clean it under slow running water. Do not use detergent or any brushes or cloths.

Cleaning the Water Tank

Remove water tank pulling it towards you. Before the tank is completely removed raise it to release the clamp located under it. Use a wet cloth with mild detergent for cleaning, Rinse with fresh water, dry and reinstall tank.

External Parts Cleaning

Use mild detergent and soft cloth for cleaning.

STORAGE

Unplug the unit from the power outlet and drain all water from the unit.

Cover the air cooler if it is not being used for a long time.

The unit should be stored in a dry place, inaccessible to children.



Installing, cleaning the air cooler fan. Always ensure that the cooler is unplugged when not in use

TROUBLESHOOTING

Faults	Reasons	Solutions
Fan not working	<ul style="list-style-type: none"> No power No operation Unit is damaged 	<ul style="list-style-type: none"> Send for repair
The unit cannot be switched off	<ul style="list-style-type: none"> "ON/OFF" button is not pressed. Safety switch is released Spare parts are damaged 	<ul style="list-style-type: none"> Press the "ON/OFF" button to turn the unit off Check that the rear filter is inserted properly to deactivate the safety switch Send into repair centre.
The unit made an abnormal noise	<ul style="list-style-type: none"> Dust caught in fan The motor is out of order 	<ul style="list-style-type: none"> Remove the objects Send into repair centre.
Lack of humidity	<ul style="list-style-type: none"> Low water level or lack of water Water pipe not aligned The pump is out of order 	<ul style="list-style-type: none"> Refill water tank Reconnect the water pipe Send into repair centre.
Oscillation on Swing function	<ul style="list-style-type: none"> The motor is damaged 	<ul style="list-style-type: none"> Send into repair centre.
Not cool sufficiency	<ul style="list-style-type: none"> Rear Filter blocked by dust Not enough water Cooler button not pressed 	<ul style="list-style-type: none"> Wash the Rear filter Add water to correct level Press the Cool Air button

The safety switch system will stop the unit automatically when the back cover is removed.

Please clean the filtering system frequently to maintain your unit in good working order. Never immerse the unit, power cord or plug into water.

Do not attempt to repair this unit yourself; only approved technicians are authorised to repair it.

TECHNICAL DATA

Item number	ACS101
Discription	Evaporative Twin Fan Air Cooler
Voltage (V) Hz	230V-240V ~ 50Hz
Electric power	70W
Cooling area	
Dimensions	330 x 300 x 800mm
Weight	3.2 kg
Water capacity	1.3 Litres
Any modification to the Evaporative Twin Fan Air Cooler may cause injury or property damage.	
Any modification to the Evaporative Twin Fan Air Cooler will invalidate the warranty on this appliance.	

AFTER SALES SERVICE

MANUFACTURED FOR AND DISTRIBUTED BY ALVA MARKETING
Alva Air, a division of Stingray Accessory Manufacturers
(Pty) Ltd.
P.O. Box 30014
Tokai, 7966
Tel: 021 442 1540
E-mail: info@stingray.co.za
www.alva.co.za
 www.facebook.com/alvaelectricsa
TOLL FREE NUMBER
086 100 ALVA (2582)



Should you experience problems with this Air Cooler, carry out the necessary checks as per the Trouble Shooting Guide.

If you are still unable to correct the problem with the information in this guide, contact your nearest dealer or ALVA: 086 100 (ALVA) (2582) or e-mail info@stingray.co.za